



THE TOWER, ONE ST GEORGE WHARF, NINE
£1,150,000



A seventh floor 643 sq ft one bedroom apartment for sale in the ultra high-specification One St. George Wharf. This building offers the highest in design and style, whilst being located on the water's edge in the heart of central London. All apartments have valet parking inclusive, and the building offers dedicated door service, 24 hour concierge, private health club with gym, infinity swimming pool, sauna and steam room, business facilities including a boardroom with conference facility, a business lounge and a private screening room and landscaped exterior gardens. Available chain free to view immediately.



THE TOWER, ONE ST. GEORGE WHARF

SEVENTH FLOOR

GROSS INTERNAL AREA 643 SQ FT

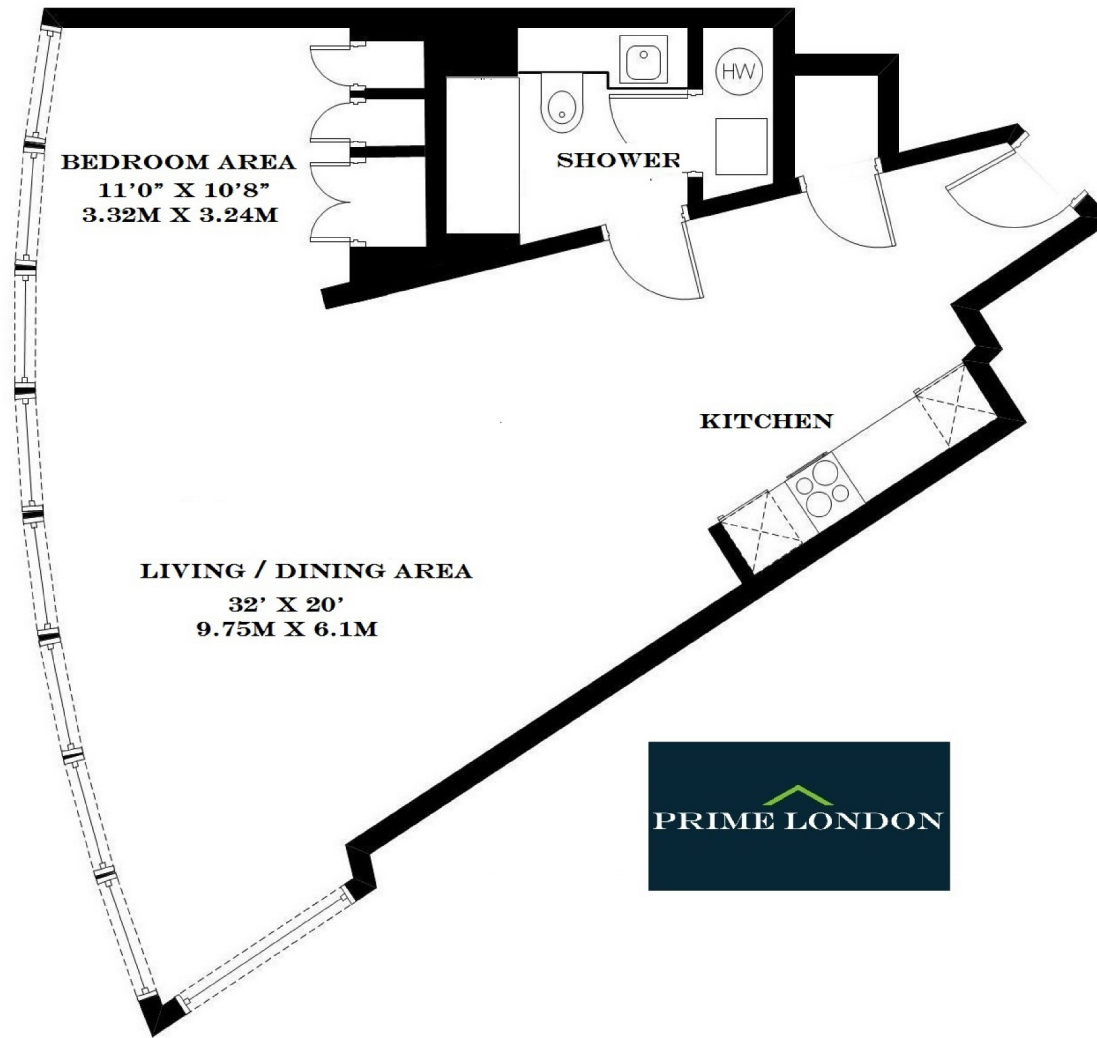



CONFERENCE ROOM



LOBBY

