



PROVIDENCE TOWER, CANARY WHARF
FIXED ASKING PRICE £456,000



PROVIDENCE TOWER, BISCAIYNE AVENUE, LONDON E14

THIRTY-FIRST FLOOR

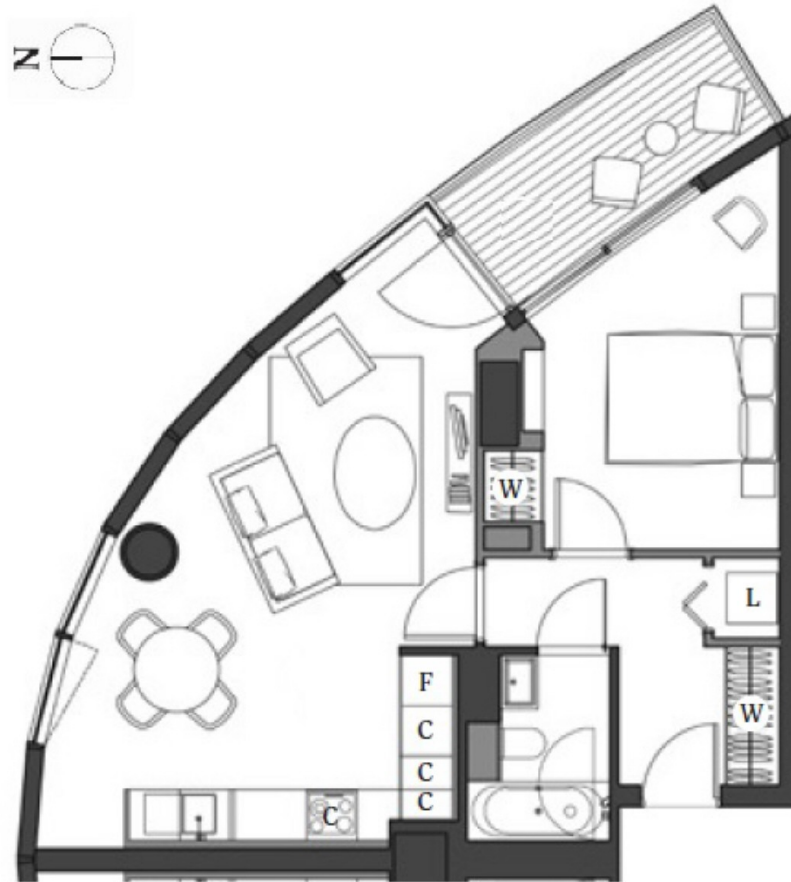

1 Bedroom

Total area

553.4sqft / 51.4sqm

Living / Kitchen

7100 x 4800mm

Bathroom

2200 x 1700mm

Bedroom

4815 x 2800mm

Balcony

68.9sqft / 6.4sqm