



Bromley BR2
£135,000

jdm
ESTATE AGENTS

Description:

Warden assisted one bedroom first floor flat located in a quiet residential road close to bus routes, shops, and local amenities. The kitchen, with space and plumbing for washing machine (washing line available for drying outside), is open plan to the comfortable lounge. There is a bathroom and large storage cupboard.

The communal grounds are well tended and there is a summerhouse where the residents can meet for coffee etc. There is ample off street parking on a first come first serve basis.

Please contact jdm for an internal viewing.



Directions: From Bickley Station turn right into Southborough Road. At the third roundabout at the end of the road turn left into Southborough Lane and take the 2nd right into Magpie Hall Lane.

Tenure: Leasehold

Council Tax Band: B

Local Authority: London Borough of Bromley



Room Dimensions:

Lounge	14'3 x 10'0
Kitchen	7'7 x 5'7
Bedroom	11'2 x 8'10
Bathroom	7'8 x 5'3

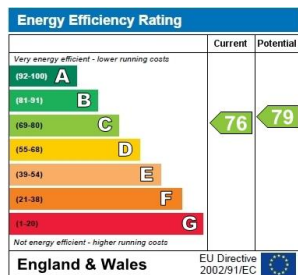

Please contact the branch for a complete copy of the EPC document

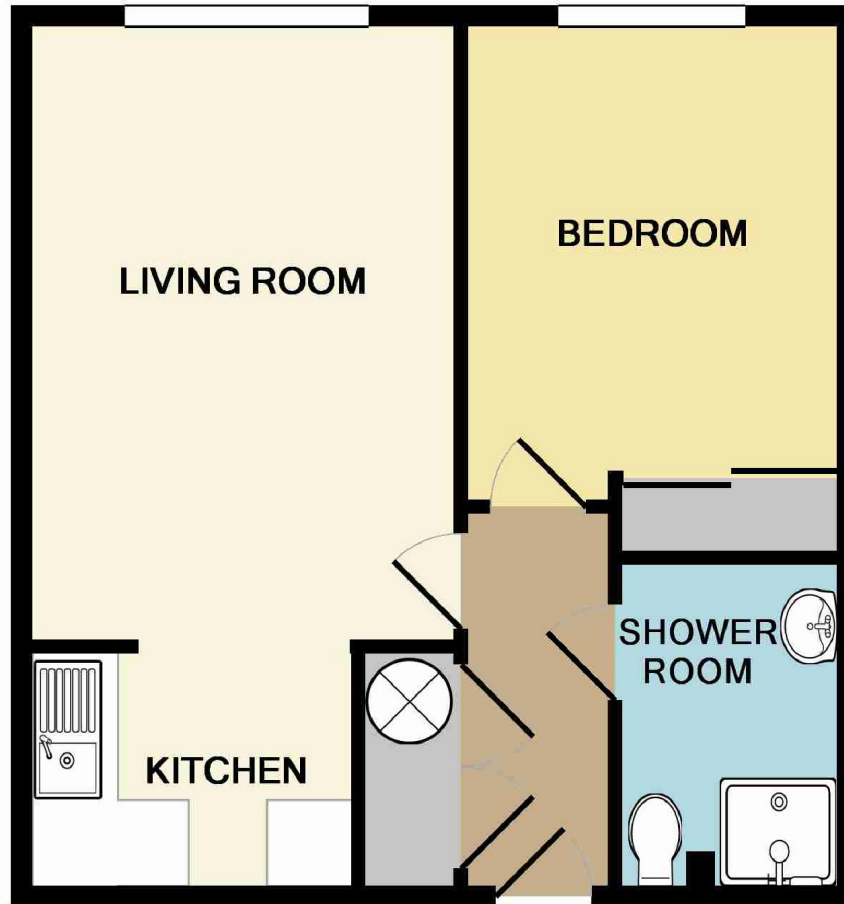

TOTAL APPROX. FLOOR AREA 384 SQ.FT. (35.7 SQ.M.)

Whilst every attempt has been made to ensure the accuracy of the floor plan contained here, measurements of doors, windows, rooms and any other items are approximate and no responsibility is taken for any error, omission, or mis-statement. This plan is for illustrative purposes only and should be used as such by any prospective purchaser. The services, systems and appliances shown have not been tested and no guarantee as to their operability or efficiency can be given

Made with Metropix ©2015

IMPORTANT NOTICE

jdm must advise that although every effort has been made to ensure the accuracy of these details they form no part of any contract and are issued without any responsibility on the part of the agents or vendor. Photographs may have been taken using a wide angle lens. Any floor plans shown are not to scale. All measurements, walls, doors, windows, fittings and appliances, their sizes and locations are shown conventionally and are approximate only. Any reference to alterations or particular use of the property wherever stated, is not a statement that planning, building regulations or other relevant consent has been obtained. We have not carried out a survey of the property nor have we tested any services, systems or appliances at this property. We strongly recommend that all the information we provide is verified by yourselves on inspection and by your Surveyor and Solicitor or Legal Adviser.

jdm recommends Independent Mortgage Advice. For help with your mortgage please contact your local branch. Your home may be repossessed if you do not keep up repayments on your mortgage. Written quotations available on request.

jdm Petts Wood

36 Station Square, Petts Wood, Kent BR5 1NA

01689 819 819

epw@jdmonline.com



jdm
ESTATE AGENTS