







We are pleased to offer this one double bedroom first floor flat, of large proportions, within this charming character property half a mile from Chislehurst station and local shops.

The property comprises large entrance hall, a modern fitted kitchen with integral appliances, the double bedroom overlooks the garden and has quality fitted wardrobes. The bathroom has a modern suite and is tiled with a shower over the bath. The living room is a wonderful feature of this property offering a very large living space full of character charm and overlooks the maintained communal garden.

The property benefits from residents and guest parking. There are well kept communal gardens to the rear for residents to enjoy.



The location is excellent and highly favoured being within close proximity to the common, cricket ground and local amenities. Early viewing to avoid disappointment is highly recommended.



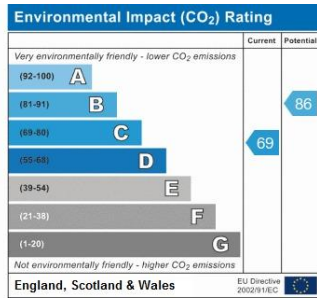
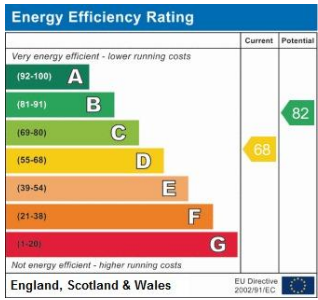

Please refer to

---

[www.jdmestateagents.com](http://www.jdmestateagents.com)

---

to view our full area guides



# Morland House

APPROX. GROSS INTERNAL FLOOR AREA 659.72 SQFT / 61.29 SQM

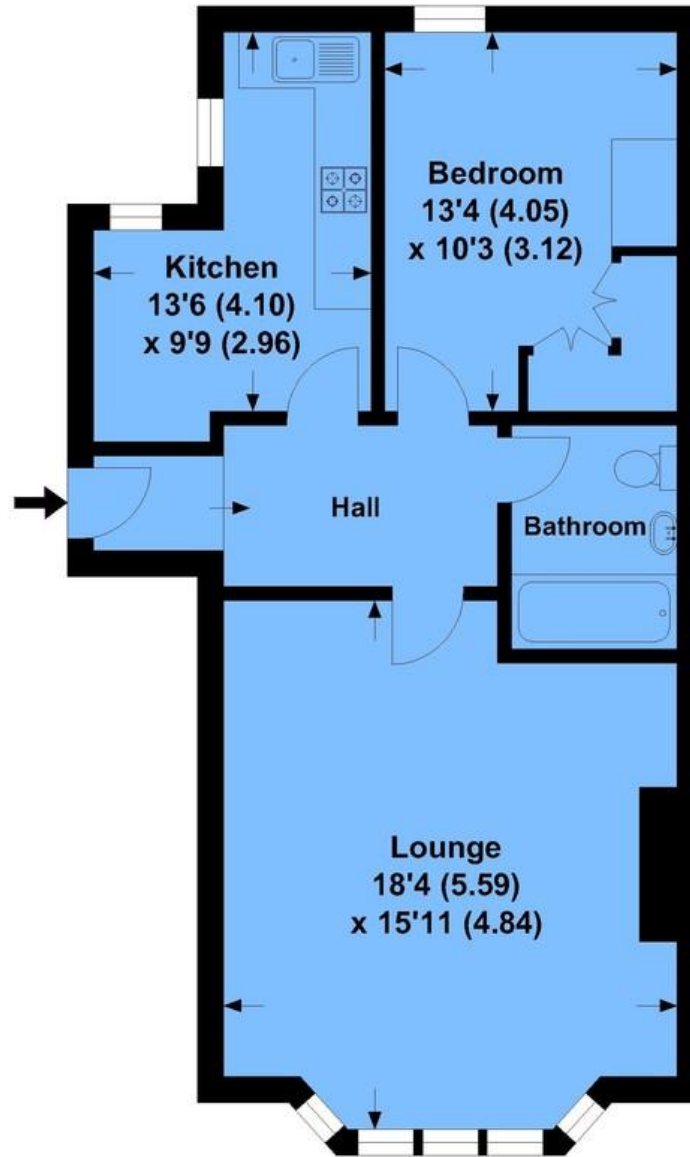

This is for guidance only, not to scale and must not be relied upon as a statement of fact.  
Attention is drawn to the notice on these particulars.

