

jdm must advise that although every effort has been made to ensure the accuracy of these details they form no part of any contract and are issued without any responsibility on the part of the agents or vendor. Photographs may have been taken using a wide angle lens. Any floor plans shown are not to scale. All measurements, walls, doors, windows and appliances, their sizes and locations are shown conventionally and are approximate only. Any reference to alterations or particular use of the property wherever stated, is not a statement that planning, building regulations or other relevant regulations and approvals have been obtained. We have not carried out a survey of the property nor have we tested any services, systems or appliances at this property. We strongly recommend that all the information we provide is verified by your surveyor and solicitor or legal adviser. jdm recommends Independent Mortgage Advice. For help with your mortgage please contact your local branch. Your home may be repossessed if you do not keep up repayments on your mortgage. Written quotations available on request.

Whilst every attempt has been made to ensure the accuracy of the floor plan contained here, measurements of doors, windows, rooms and any other items are approximate and no responsibility is taken for any error, omission, or mis-statement. This plan is for illustrative purposes only and should be used as such by any prospective purchaser. The services, systems and appliances shown have not been tested and no guarantee as to their operability or efficiency can be given
Made with Metropix ©2013

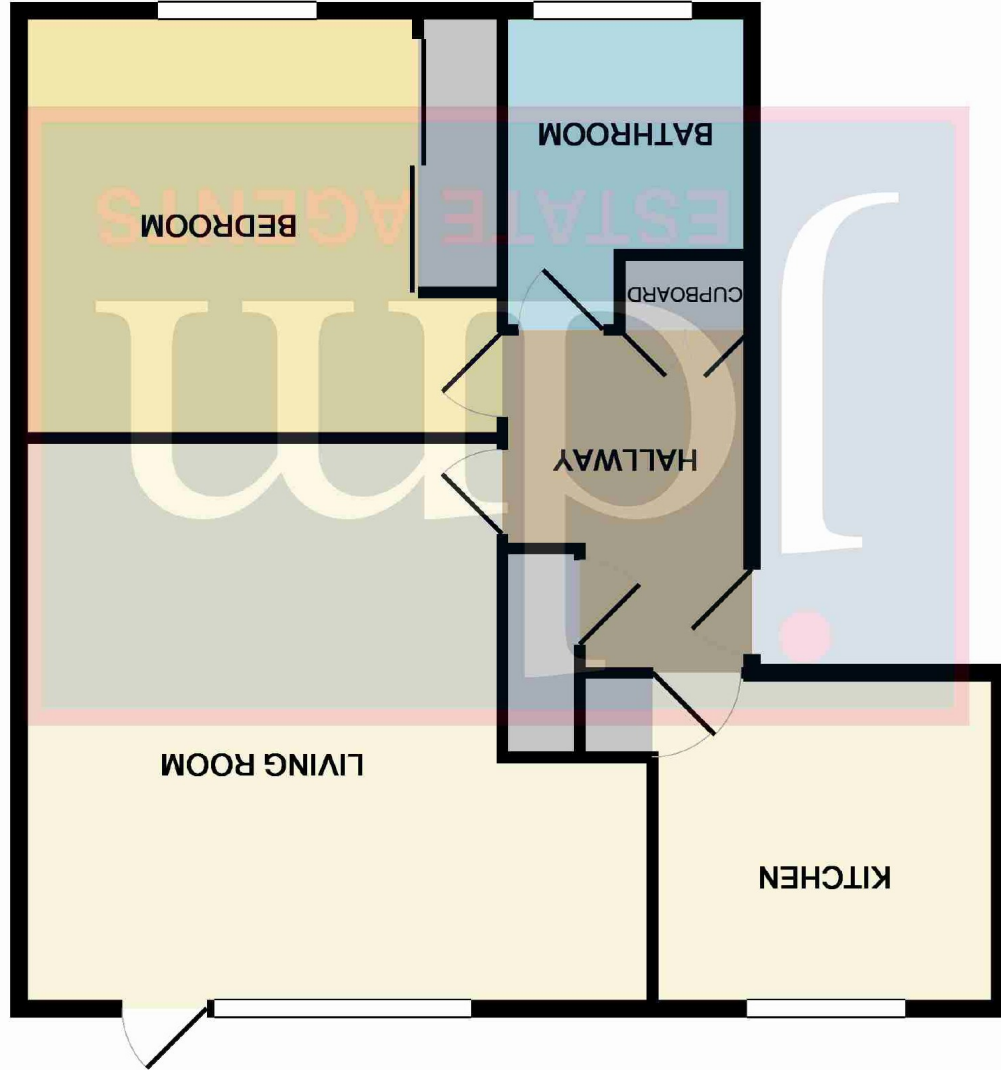

Faro Close, Bromley
£950 Per calendar month

Description:

Newly refurbished to a very high standard, this one bedroom ground floor flat is a stone's throw from Chislehurst mainline station (London Bridge c 20 minutes), and walking distance to local shops.

Comprising spacious living room with laminate flooring and door to patio and communal garden, newly fitted kitchen with oven and hob, plus washer/drier and fridge freezer if required, double bedroom with large wardrobe, and newly fitted shower room. Gas central heating, double glazing and allocated parking.

Offered unfurnished. Available now. Viewing strongly recommended.

Energy Rating D, Council Tax band C.



Directions: From Chislehurst Station turn right out of the station entrance, right into under railway bridge into Summer Hill, turn left into Cotes Hill Road, and left again into Faro Close, where the property will be found on the left.

Tenure:

Council Tax Band: C

Local Authority: Bromley



Room Dimensions:

Living Room	15'11 x 13'9 / 17'8 L-shaped
Bedroom	13'9 x 11'11
Kitchen	9'9 x 7'0
Bathroom	8'11 x 7'0
Hallway	8'3 x 7'0



Please refer to www.jdmstateagents.com to see our full Area Guides.

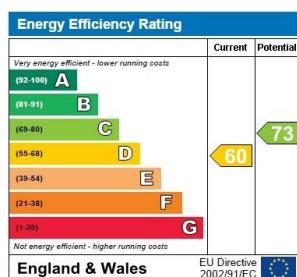

Please contact the branch for a complete copy of the EPC document

