

hillyards.



Hillyards Estate Agents are pleased to offer this one bedroom house with private garden situated on the Hawkslade area of Aylesbury. The property will make an ideal investment or first time buy and is being marketed with no onward chain. Accommodation consists of lounge, kitchen, bedroom and bathroom as well as garden and allocated parking.

£185,000 Freehold

Anton Way, Aylesbury, Buckinghamshire. HP21 9HS

Anton Way, Aylesbury, Buckinghamshire. HP21 9HS

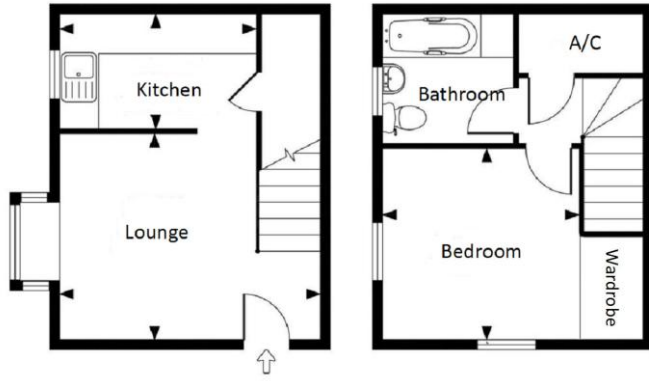

Accommodation

Lounge 16'4 x 10'6 (4.98m x 3.20m)

Kitchen 8'6 x 5'11 (2.59m x 1.80m)

Landing

Bedroom 13'1 x 9'8 (3.99m x 2.95m)

Bathroom

Gardens

There is an enclosed private garden to the rear of the property laid to lawn.

Parking

There one allocated parking bay situated to the rear of the property.

Property Information

Map

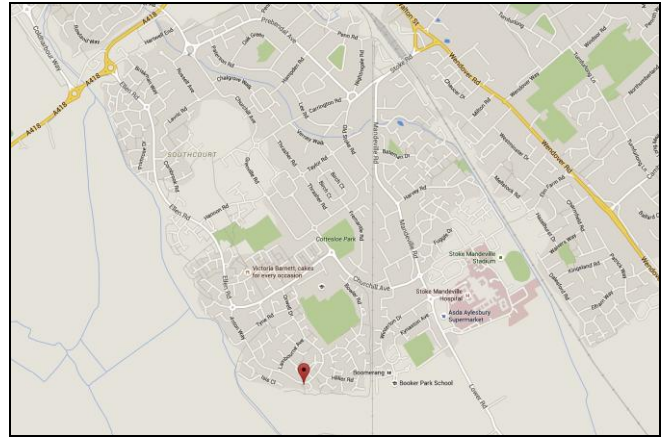

Council Tax Band

B (approximately £1183.00 per annum based on 2 adults residing at the property)

Energy Performance Graph

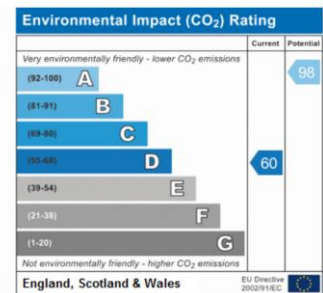
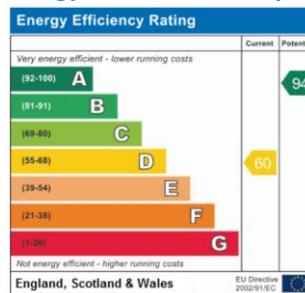

Property Misdescription Act 1991: For clarification, we wish to inform prospective purchasers that we have prepared these sales particulars as a general guide. We have not carried out a detailed survey nor tested the services, appliances and specific fittings. Room sizes should not be relied upon for carpets and furnishings. No person representing HILLYARDS has any authority to make or give any representation or warranty whatever in relation to this property.

Money Laundering Regulations 2003: Intending purchasers will be asked to produce two forms of identification documents and we would ask for your prompt co-operation in order that there will be no delay in agreeing the sale.

Deposit: Please note that HILLYARDS take and hold a £250.00 deposit from the potential purchaser at the point of an offer being accepted in order for the property to be taken off the market.

Property Details: Awaiting vendors approval, Every care has been taken with the preparation of these particulars but they are for general guidance only and complete accuracy cannot be guaranteed. If there is any point, which is of particular importance please ask, or professional verification should be sought. All dimensions are approximate.