



**DISCOUNTED SELECTION, ROYAL WHARF**  
**PRICES FROM £430,000**



20-30% cheaper than current prices, exclusive to Prime London, the only opportunity to buy two bedroom apartments at phase 1 prices in Royal Wharf. The payment structure is 20% of purchase price to exchange contracts, with 80% on completion. This property is available as an off-plan investment sale, with the right for multiple assignments, for completion in 2016. Royal Wharf will consist of 3,385 homes in total, a beautiful riverside walkway, new streets, connecting parks and squares, with the apartment buildings offering very generous 'family sized' apartments. Royal Wharf is located directly next to a new 35 acre development by ABP China, the largest development of its kind in the UK. This state-of-the-art business district will act as a platform for financial, high-tech and knowledge-driven industries looking to establish and drive forward their business in UK and European markets. This site represents one of the first direct investments by a Chinese developer in London's property market and will eventually be home to over 3.2 million square feet of high quality work, retail and leisure space, including 2.5 million square feet of prime office space, creating a new, vibrant 24/7 district on London's waterways.



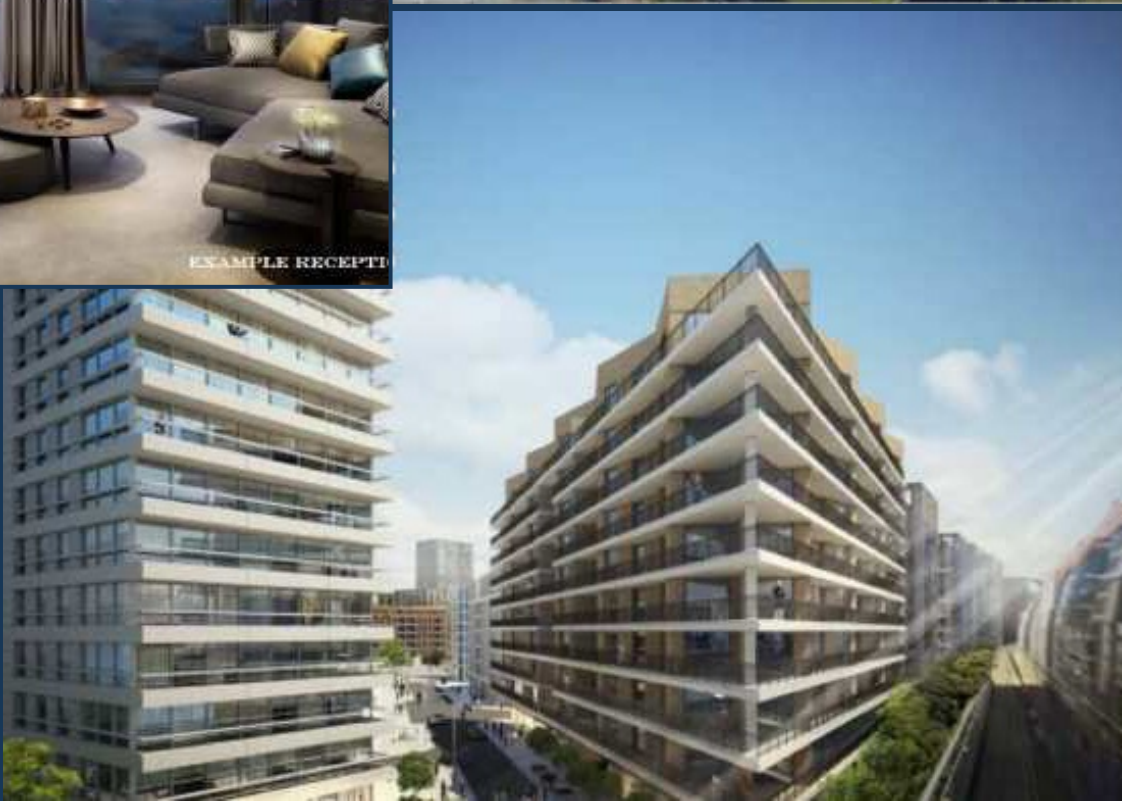





# PRIME LONDON

SALES LETTINGS ACQUISITIONS ASSET MANAGEMENT

## NEW HOMES AND INVESTMENTS