

**Samuel  
James**  
ESTABLISHED 1991

Residential Sales & Lettings

**Caversham Place  
Reading  
Berkshire  
RG1 8BY**

**£319,950  
(Leasehold)**

**Sought after location**

**Short walk to Reading Mainline  
Train Station**

**No onward chain complications**

**Secure gated parking**



[www.samueljamesproperties.co.uk](http://www.samueljamesproperties.co.uk)

**SAMUEL JAMES**

**Samuel James** presents to you this two bedroom executive third floor apartment located in the sought after location of Caversham borders. The property is located close to Caversham High Street, River Thames and a short walk to the train station and town centre.

This property also benefits from a balcony and gated parking.

**Entrance Hall:**

Offers access to storage cupboard, airing cupboard, intercom system and doors to...

**Lounge/Diner/Kitchen:**

Built in washer, integral oven and hob with space for fridge freezer. Access to balcony.

**Master Bedroom:**

Includes an en-suite.

**Bedroom Two**

**Bathroom:**

Shower over bath, hand basin and W/C, extractor.

**Key points:**

- No onward chain complications
- Walking distance to all local amenities & train station
- Popular location

**Lease:** 145 years

**Service charge:** £1600 per annum approx

**Ground rent:** £299 per annum approx

**Local Authority:** Reading Borough Council

0118 956 9595

[www.samueljamesproperties.co.uk](http://www.samueljamesproperties.co.uk)

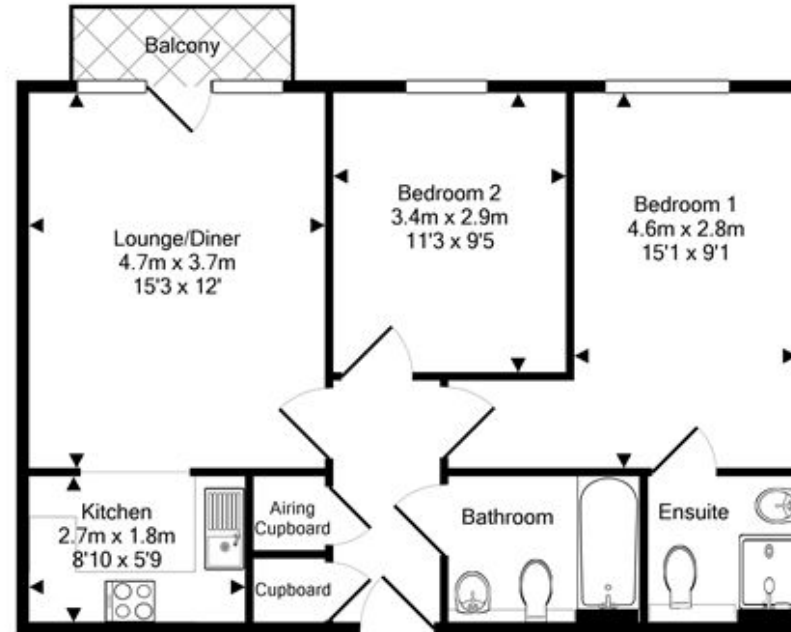

Total Approx. Floor Area 59.6 Sq.M. (642 Sq.Ft.)  
Measurements are approximate. Not to scale. Illustrative purposes only  
Made with Metropix ©2016



*THE AGENT HAS NOT TESTED ANY APPARATUS, FITTINGS OR SERVICES AND SO CANNOT VERIFY THEY ARE IN WORKING ORDER. THE BUYER IS ADVISED TO OBTAIN VERIFICATION FROM HIS/HER SOLICITOR OR SURVEYOR. IN THE CASE OF AN EXTENSION OR CONVERSION, THE AGENT HAS NOT VERIFIED ANY PLANNING CONSENTS OR BUILDING REGULATION APPROVAL THAT MAY BE REQUIRED. Samuel James Estate Agents, for themselves and for the seller of this property advise that; these particulars do not constitute any part of an offer or contract. All statements in these Particulars are made without liability on the part of Samuel James Estate Agents or the seller. They should not be relied upon as a statement or representation of fact. Any intending buyer must satisfy themselves as to their correctness. No representation or warranty whatsoever in relation to this property is made by the seller or Samuel James or any of its employees has any authority to make the same.*

*Misrepresentation Act, 1967*

*Although every care is taken in preparing these particulars they do not constitute an offer or contract, or any part hereof. Statements contained therein are not to be relied on as statements or representation of fact and are made without responsibility on the part of the Agents or Vendor. An intending purchaser must satisfy himself by inspection, or otherwise as to the correctness of each statement and the Vendor does not make or give and neither have the Agents or their employees authority to make or give and representation or warranty in relation to this property.*

**SAMUEL JAMES**



 **rightmove.co.uk**  
The UK's number one property website

**Zoopla.co.uk**

 **PrimeLocation.com**

 **The Property Ombudsman**

0118 956 9595

[www.samueljamesproperties.co.uk](http://www.samueljamesproperties.co.uk)

**SAMUEL JAMES**