

GARDENS

FLOOR PLANS

This plan is included as a service to our customers and is intended as a guide to layout only. 'Dimensions are approximate do not scale.'

Please type or click this weblink to see interactive floor plans

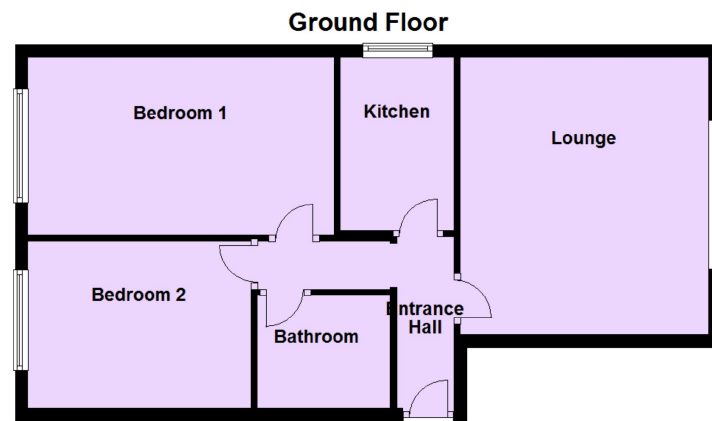

LOCATION

ENERGY PERFORMANCE CERTIFICATE



£425 Per month

4 Worsley Gardens, Walkden, Worsley, Manchester, M28 3ST

- 2 Bedroom Apartment
- Second Floor Apartment
- Lounge, Fitted Kitchen
- Storage Heating,d/glazed
- Security Gates / Intercom
- Allocated Parking

We are pleased to offer for rental this two bedroom second floor apartment, situated within easy access of; Walkden town centre and all its amenities. Offered unfurnished

NOTE TO PROSPECTIVE PURCHASERS

Should you wish to make an offer on one of our properties we would advise you to contact our office in the first instance, prior to contacting your lender or solicitor, to avoid incurring any unnecessary costs.

Russell James offer a free valuation service to any prospective purchaser looking to sell their property. This service is provided without obligation.

Russell James also offers a free independent mortgage advice service. This service is provided without obligation.

SECOND FLOOR

ENTRANCE HALL

Open plan to Entrance Hall, door to:

LOUNGE / DINING AREA

4.37m x 3.96m (14'4" x 13'0")

Window to front.

FITTED KITCHEN

2.69m x 1.83m (8'10" x 6'0")

Fitted with a range of wall and base units with co-ordinating worktops, electric oven and hob with extractor over, space for washing machine and fridge/freezer. Partially tiled walls and window to side.

BATHROOM

2.11m x 1.70m (6'11" x 5'7")

Fitted with a three piece suite comprising of: panelled bath with shower mixer taps, pedestal wash hand basin and low level w.c. Partially tiled walls.

BEDROOM 1

4.80m x 2.69m (15'9" x 8'10")

Double room, window to rear.

BEDROOM 2

3.07m x 2.77m (10'1" x 9'1")

Double room, window to rear.

COMMUNAL GARDENS

There are communal gardens to the property with electric gates and allocated parking.

FLOOR PLAN - GROUND FLOOR

This plan is included as a service to our customers and is intended as a GUIDE TO LAYOUT only. Dimensions are approximate.

DO NOT SCALE.

LOCATION

From our office on Newearth Road proceed towards Walkden, at roundabout take 2nd exit onto Bridgewater Road, at end turn left onto Memorial Road, at lights go straight ahead onto Bolton Road, following road along then turn left onto Mountain Street and Worsley Gardens are on left, with N04 being in the 3rd block.



BEDROOM 2



BEDROOM 1



BATHROOM