

Neville House, 67 Wellingborough Road,  
Rushden, Northamptonshire, NN10 9YG  
T: 01933 316316  
E: sales@mike-neville.co.uk  
www.mike-neville.co.uk

**Mike  
Neville**  
ESTATE AGENTS



**8 Pine Close, Rushden  
Northamptonshire NN10 9HD**



**£165,000 Freehold**

We, the Sole Selling Agents, are delighted to offer for sale this very appealing, extended, semi detached bungalow in a rarely available cul-de-sac location just off Lodge Road.

This Underwood constructed bungalow benefits from two double bedrooms, extended lounge, separate dining room, kitchen addition and bathroom/w.c. Externally, one will find front and rear gardens, tandem carport and garage.

The property further benefits from PVC double glazing and gas radiator central heating.

An early viewing is certainly advised.

#### Location

Situated off Lodge Road, in between Cedar Close and Poplar Close, with Lodge Road itself situated between Abbey Way and Grangeway. The property can be found as identified by our for sale board. Viewings should be made strictly via ourselves the Sole Selling Agents on 01933 316316.

#### Council Tax Band

C

#### Energy Rating

D

#### Accommodation

##### Hall

Lounge 11'1" x 10'11" plus 7'8" x 10'8" (3.40m x 3.35m plus 2.35m x 3.26m)



Dining Room 7'10" x 12'2" (2.38m x 3.71m)



Kitchen 7'1" x 12'2" (2.16m x 3.71m)



Bedroom 1 13'0" x 11'0" (3.97m x 3.35m)

Maximum measurement including built in wardrobes



Bedroom 2 8'11" x 9'1" (2.73m x 2.78m)

Maximum measurement

#### Bathroom/W.C

##### Additional Information

Hot water cylinder situated in airing cupboard in bathroom.  
Wall mounted gas fired boiler situated in cupboard in hallway.  
Loft access in hallway.  
PVC double glazing  
Gas radiator central heating.  
No upward chain.

#### Outside

##### Front

Driveway approach providing off road parking with pleasant area of front garden.

##### Tandem Carport

Leading to garage.

##### Garage

Up and over door to front.

##### Rear Garden

Fully enclosed and completely private with hedgerow, many shrubs, etc. The garden is of low maintenance.



#### Disclaimer

AGENTS NOTE - ALL MEASUREMENTS ARE APPROXIMATE. ANY APPLIANCES MENTIONED HAVE NOT BEEN TESTED BY OURSELVES. MONEY LAUNDERING REGULATIONS 2007 – We are required to show due diligence in obtaining proof of identity on or before the date the purchaser's offer is accepted by the vendor (seller). Floor plans are for identification purposes only and not to scale. Measurements are approximate. Wall thickness, door and window sizes are approximate. Prospective purchasers are strongly advised to check all measurements prior to purchase. Mike Neville Estate Agents for themselves and the Vendors/Lessors of this property, give notice that (a) these particulars are produced in good faith as a general guide only and do not constitute or form part of a contract (b) no person in the employment of Mike Neville has authority to give or make any representation or warranty whatsoever in relation to the property.



## Ground Floor

Approx. 70.8 sq. metres (762.1 sq. feet)

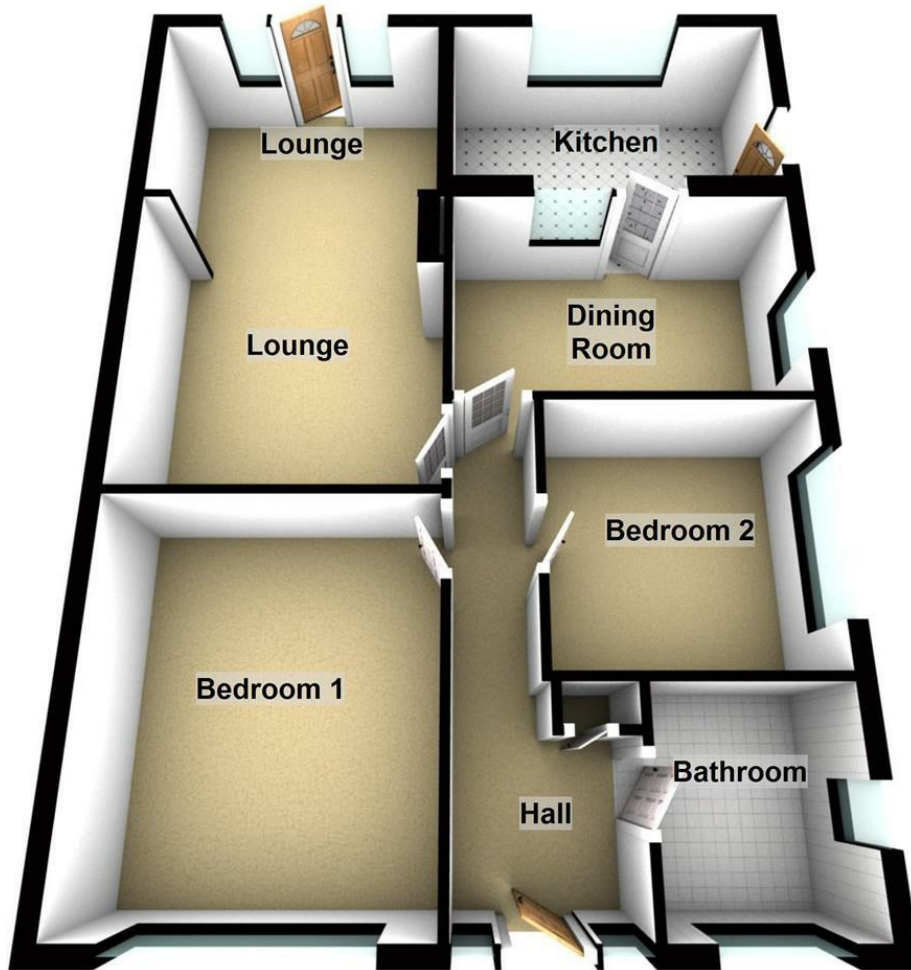

Total area: approx. 70.8 sq. metres (762.1 sq. feet)

*Sales and Lettings Offices*



RUSHDEN  
01933 316316

BEDFORD  
01234 327455

WOBURN  
01525 290393

HITCHIN  
01462 438979

Registered in England 4144174

*Auction Rooms*  
**CHARLES ROSS**  
**FINE ART AUCTIONEERS**  
**AND VALUERS**  
01525 290502