

**Dolphin Close
Aldermaston
West Berkshire
RG7 4NL**

£210,000 (70% share)
(Leasehold)

Semi-Detached

Two good sized bedrooms

Recently refurbished bathroom

Beautiful location



Description

Located within highly desirable surroundings on the edge of Aldermaston Village with scenic views of West Berks countryside. A rare opportunity for a first time buyer to acquire a 70% share of a well presented two bedroom semi-detached house.

Offering spacious accommodation with larger than average bedrooms, newly refurbished bathroom and brand new state of the art heating system.

The property is well established and provides off road parking for two to three cars and an enclosed westerly facing rear garden

Entrance Hall

Offers access to storage cupboard, fuse board and...

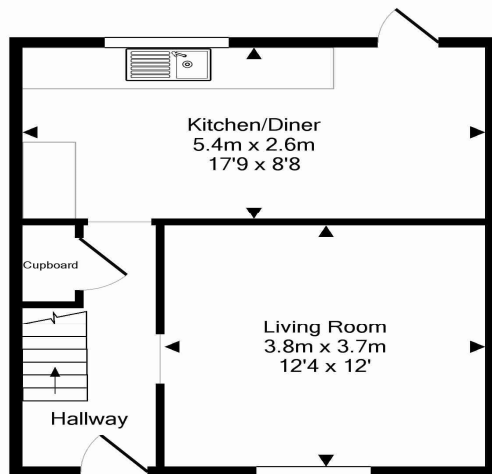

Ground Floor
Approx. Floor
Area 34.2 Sq.M.
(368 Sq.Ft.)

Kitchen/Diner:

Rear aspect double glazed window and rear aspect door to rear garden. Offers a range of eye and base level units, rolled edge work surface with stainless steel sink and drainer with mixer tap, space for cooker, breakfast bar, and dining area.

Lounge:

Front aspect double glazed window, television and telephone point.

Bedroom one:

Front aspect double glazed window, built in wardrobe

Bedroom two:

Rear aspect double glazed window

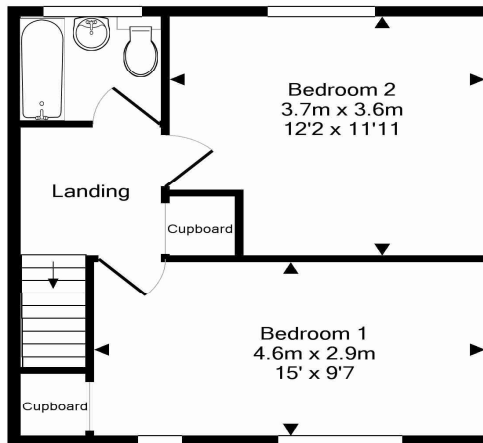

1st Floor
Approx. Floor
Area 34.3 Sq.M.
(369 Sq.Ft.)

Total Approx. Floor Area 68.5 Sq.M. (737 Sq.Ft.)
Measurements are approximate. Not to scale. Illustrative purposes only
Made with Metropix ©2016

Family Bathroom:

Newly refurbished. Rear aspect double glazed window, electric shower over bath with mixer tap, hand basin with mixer tap, WC.

Local Transport:

- Aldermaston Station (1.5 miles) accessed via recently installed footway.
- Short walk from bus stop for Newbury & Reading.

Schools:

- Aldermaston (CofE) Primary (<0.1 miles)
- The Cedars School (0.5 miles)

Lease: 99 years

Monthly Ground rent: £142.83

EPC rating: D 62

Although every care is taken in preparing these particulars they do not constitute an offer or contract, or any part hereof. Statements contained therein are not to be relied on as statements or representation of fact and are made without responsibility on the part of the Agents or Vendor. An intending purchaser must satisfy himself by inspection, or otherwise as to the correctness of each statement and the Vendor does not make or give and neither have the Agents or their employees authority to make or give and representation or warranty in relation to this property.

The floor plans are not to scale and are for information purposes only. THE AGENT HAS NOT TESTED ANY APPARATUS, FITTINGS OR SERVICES AND SO CANNOT VERIFY THEY ARE IN WORKING ORDER. THE BUYER IS ADVISED TO OBTAIN VERIFICATION FROM HIS/HER SOLICITOR OR SURVEYOR. IN THE CASE OF AN EXTENSION OR CONVERSION, THE AGENT HAS NOT VERIFIED ANY PLANNING CONSENTS OR BUILDING REGULATION APPROVAL THAT MAY BE REQUIRED. Samuel James Estate Agents, for themselves and for the seller of this property advise that; these particulars do not constitute any part of an offer or contract. All statements in these Particulars are made without liability on the part of Samuel James Estate Agents or the seller. They should not be relied upon as a statement or representation of fact. Any intending buyer must satisfy themselves as to their correctness. No representation or warranty whatsoever in relation to this property is made by the seller or Samuel James or any of its employees has any authority to make the same.





Zoopa.co.uk



0118 956 9595
info@samueljamesproperties.co.uk
www.samueljamesproperties.co.uk

Samuel James Properties
10/11 Harris Arcade
Reading RG1 1DN

0118 956 9595
www.samueljamesproperties.co.uk

SAMUEL JAMES

