



Bromley BR1
Guide price £360,000

Description:

Guide Price £360,000

A two double bedroom terrace house for sale in this quiet cul-de-sac location. The property comprises entrance hallway, open plan lounge with dining room including feature fireplace and under stairs storage. The kitchen provides access to the private rear garden, spaces for cooker, fridge/freezer and washing machine. Upstairs the master bedroom is a good size and consists of enough space to include wardrobes, feature fire place and wood flooring. The second bedroom also features a fireplace. The tiled bathroom consists of a four piece suite including shower over bath, hand basin, bidet and wc.

The property benefits from a private rear garden including patio area, garden shed and flower beds. Located in the popular area of Widmore Green in Bromley the property is local to Widmore Recreation Ground, St Georges Bickley CE Primary School, Bickley Primary School and Bickley Station.

Please contact Jdm Bromley to book your appointment.



Directions: From Bickley Station head north on Southborough Road. Take the second left onto Bickley Park Road. Turn left onto Lewes Road. The property will be on the left.

Tenure: Freehold

Council Tax Band: D

Local Authority: London Borough of Bromley



Room Dimensions:

Entrance Hallway

Lounge/Dining Room **11'07 x 27'03**

Kitchen **9'02 x 9'05**

Landing

Bedroom One **13'05 x 14'05**

Bedroom Two **8'07 x 13'05**

Bathroom **8'11 x 8'11**

Garden **14'03 x 48'10**

Loft Storage



Energy Efficiency Rating		Current	Potential	Environmental Impact (CO ₂) Rating		Current	Potential
Very energy efficient - lower running costs				Very environmentally friendly - lower CO ₂ emissions			
(92-100) A				(92-100) A			
(81-91) B				(81-91) B			
(69-80) C				(69-80) C			
(55-68) D				(55-68) D			
(39-54) E				(39-54) E			
(21-38) F				(21-38) F			
(1-20) G				(1-20) G			
Not energy efficient - higher running costs				Not environmentally friendly - higher CO ₂ emissions			
EU Directive 2002/91/EC				EU Directive 2002/91/EC			
England & Wales				England & Wales			
			60			53	78

Please contact the branch for a complete copy of the EPC document



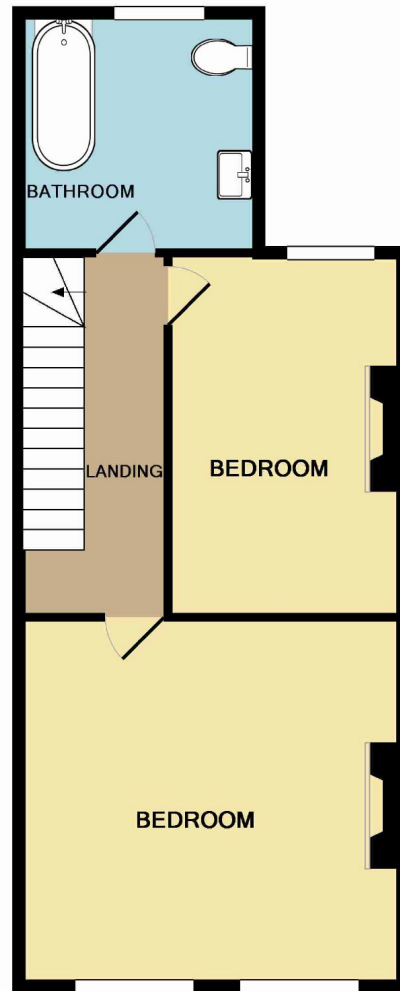
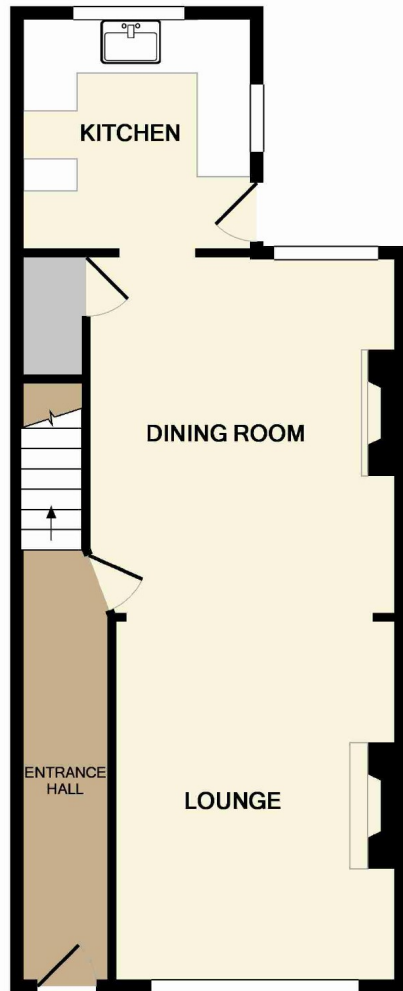

GROUND FLOOR
APPROX. FLOOR
AREA 462 SQ.FT.
(42.9 SQ.M.)

1ST FLOOR
APPROX. FLOOR
AREA 462 SQ.FT.
(42.9 SQ.M.)

TOTAL APPROX. FLOOR AREA 924 SQ.FT. (85.9 SQ.M.)

Whilst every attempt has been made to ensure the accuracy of the floor plan contained here, measurements of doors, windows, rooms and any other items are approximate and no responsibility is taken for any error, omission, or mis-statement. This plan is for illustrative purposes only and should be used as such by any prospective purchaser. The services, systems and appliances shown have not been tested and no guarantee as to their operability or efficiency can be given

Made with Metropix ©2015

IMPORTANT NOTICE

jdm must advise that although every effort has been made to ensure the accuracy of these details they form no part of any contract and are issued without any responsibility on the part of the agents or vendor. Photographs may have been taken using a wide angle lens. Any floor plans shown are not to scale. All measurements, walls, doors, windows, fittings and appliances, their sizes and locations are shown conventionally and are approximate only. Any reference to alterations or particular use of the property wherever stated, is not a statement that planning, building regulations or other relevant consent has been obtained. We have not carried out a survey of the property nor have we tested any services, systems or appliances at this property. We strongly recommend that all the information we provide is verified by yourselves on inspection and by your Surveyor and Solicitor or Legal Adviser.

jdm recommends Independent Mortgage Advice. For help with your mortgage please contact your local branch. Your home may be repossessed if you do not keep up repayments on your mortgage. Written quotations available on request.

jdm Bromley

38 High Street, Bromley, Kent BR1 1EA

020 8313 6800

br@jdmonline.com



jdm
ESTATE AGENTS