





Growing Family home? Why not come and look at this fabulous two bedroom terraced house. Lovely white gates across the front of the house. The property offers garden for the children.

The spacious L shape living room is a well-proportioned lounge area and a through kitchen. This property is tastefully decorated throughout.

Convenient to Lee station only 0.6 miles from the property.



Energy Efficiency Rating		
	Current	Potential
Very energy efficient - lower running costs		
(92-100) <b>A</b>		
(81-91) <b>B</b>		85
(69-80) <b>C</b>	71	
(55-68) <b>D</b>		
(39-54) <b>E</b>		
(13-38) <b>F</b>		

Please refer to

[www.jdmestateagents.com](http://www.jdmestateagents.com)

to view our full area guides

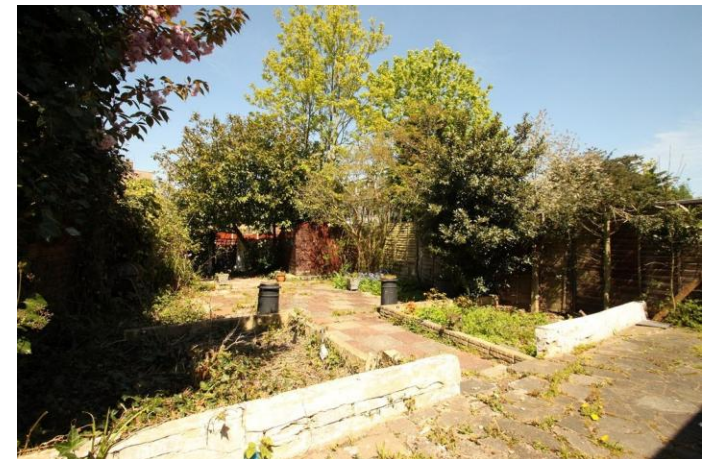

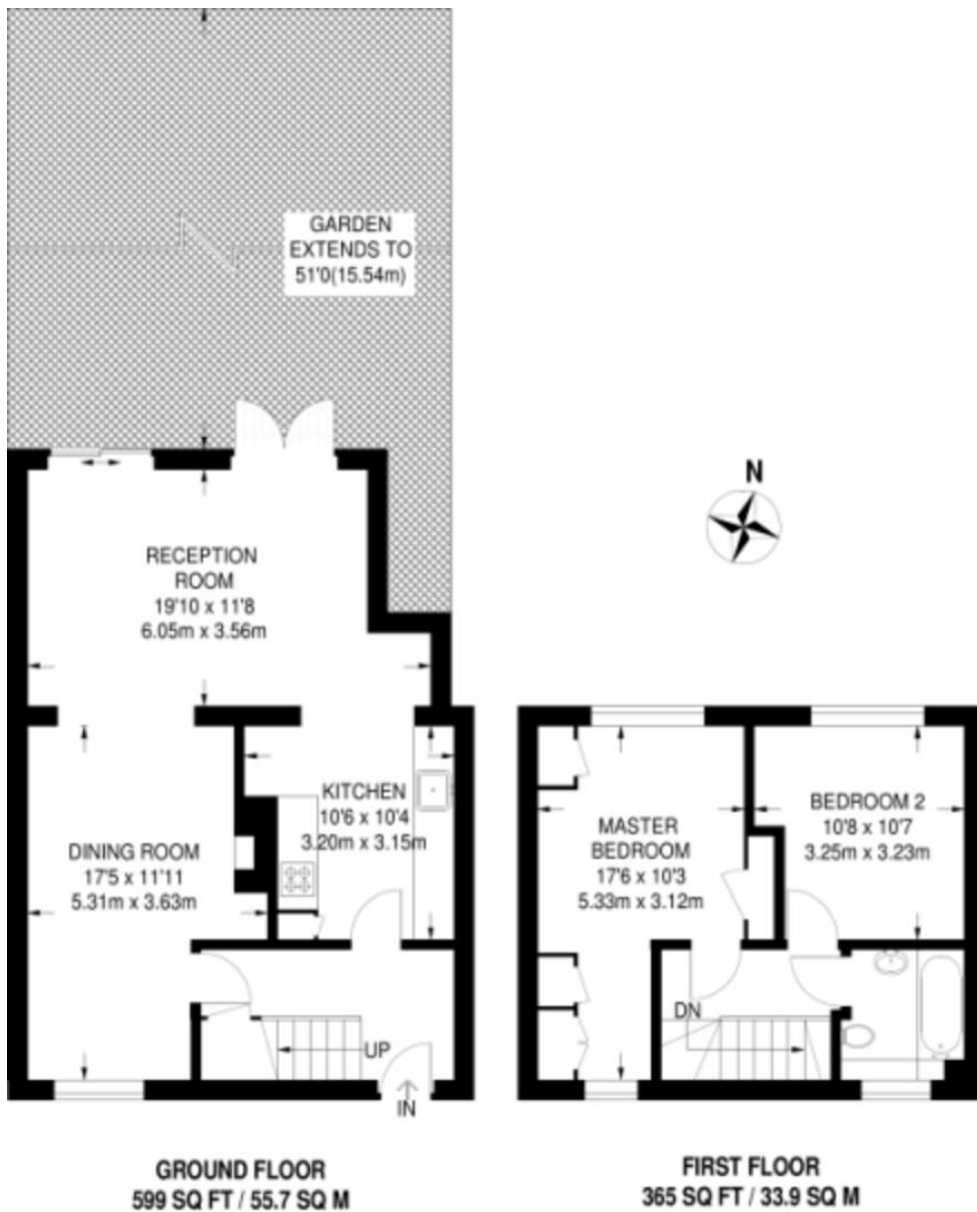

**APPROXIMATE GROSS INTERNAL AREA**  
964 SQ FT / 89.6 SQ M

