

Neville House, 67 Wellingborough Road,  
Rushden, Northamptonshire, NN10 9YG  
T: 01933 316316  
E: sales@mike-neville.co.uk  
www.mike-neville.co.uk



**3 Pytchley Road, Rushden  
Northamptonshire NN10 9XB**



**£134,950 Freehold**

\*PRELIMINARY SALES PARTICULARS - FULL INTERNAL MARKETING PHOTOGRAPHS AVAILABLE SOON\* A two bedroom mature terrace home with rear garden, offered for sale as a buy to let investment only, with the tenants in situ since 22/3/13 @ £525 pcm, looking to stay on. (The tenants would be willing to negotiate a favourable upwards rent with the new owners.) An ideal long term buy to let investment opportunity.

- Two double bedrooms
- Separate w.c
- Dining room
- Utility area
- Tiled roof
- Bathroom with separate shower
- Lounge with bay window
- Kitchen with pantry
- PVC double glazing & gas radiator central heating
- Front forecourt and small enclosed rear garden with shed & outside store

### Location

Pytchley Road is situated off Washbrook Road and links through to Oakley Road, with the property being found towards the Oakley Road end of Pytchley Road, as identified by our for sale board. Viewings should be made strictly via ourselves the Sole Selling Agents on 01933 316316.

### Council Tax Band

A

### Energy Rating

D

### Accommodation

#### Ground Floor

##### Hall

**Lounge 10'4" x 10'4" (3.15m x 3.15m)**

Bay window to front.



**Dining Room 11'4" x 10'4" (3.46m x 3.15m)**



**Kitchen 11'1" x 6'9" (3.39m x 2.06m)**



**Utility Area 4'5" x 4'7" (1.35m x 1.40m)**

**Store 4'5" x 4'7" (1.35m x 1.40m)**

Very approximate.

#### First Floor

**Bedroom 1 10'4" x 13'0" (3.15m x 3.96m)**

**Bedroom 2 11'4" x 6'8" (3.46m x 2.02m)**

**Bathroom/Shower Room**



**Separate W.C**

**Landing**

### Additional Information

Wall mounted gas fired boiler for central heating and hot water situated in utility area. Loft access on landing.

**Outside**

**Front Forecourt**

**Rear Yard & Rear Garden**

With shed and outside store. Side gated access for personal use only.

### Disclaimer

AGENTS NOTE - ALL MEASUREMENTS ARE APPROXIMATE. ANY APPLIANCES MENTIONED HAVE NOT BEEN TESTED BY OURSELVES. MONEY LAUNDERING REGULATIONS 2007 – We are required to show due diligence in obtaining proof of identity on or before the date the purchaser's offer is accepted by the vendor (seller). Floor plans are for identification purposes only and not to scale. Measurements are approximate. Wall thickness, door and window sizes are approximate. Prospective purchasers are strongly advised to check all measurements prior to purchase. Mike Neville Estate Agents for themselves and the Vendors/Lessors of this property, give notice that (a) these particulars are produced in good faith as a general guide only and do not constitute or form part of a contract (b) no person in the employment of Mike Neville has authority to give or make any representation or warranty whatsoever in relation to the property.



**Ground Floor**  
Approx. 37.7 sq. metres (406.3 sq. feet)

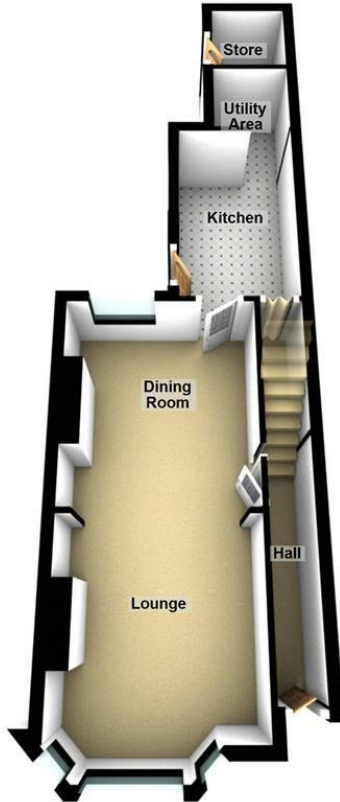

**First Floor**  
Approx. 33.6 sq. metres (361.6 sq. feet)

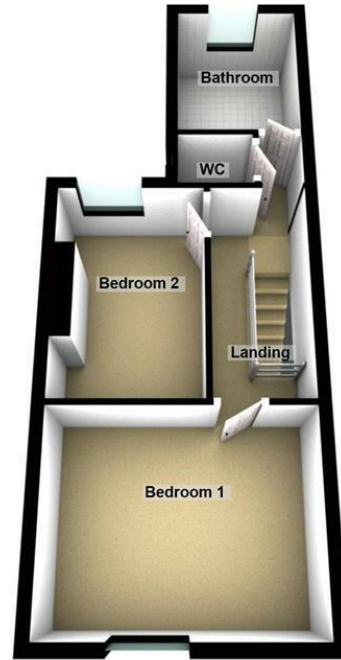

Total area: approx. 71.3 sq. metres (767.9 sq. feet)

*Sales and Lettings Offices*

RUSHDEN      WOBURN  
01933 316316    01525 290393

BEDFORD      HITCHIN  
01234 327455    01462 438979

*Auction Rooms*

WOBURN 01525 290393  
BANBURY 01295 817777



Rushden's Longest Serving Estate Agency



Neville House, 67 Wellingborough Road,  
Rushden, Northamptonshire NN10 9YG  
01933 316316

sales@mike-neville.co.uk

Open 7 Days a Week

www.mike-neville.co.uk

Registered in England 4144174