



Flat 5, 2 Yelverton Road, Bournemouth, Dorset, BH1 1DF  
£139,950

**newstead**  
ESTATE & LETTING AGENTS



Entering the flat you have a good sized kitchen and a huge lounge area which has a large bay window and an under the stair storage cupboard. The rooms have high ceilings and have retained all of the periodic features such as the fire place. Upstairs there are 2 large double bedrooms and a bathroom.

This is a lovely, bright property and with tenants in could potentially provide you with a 6% yield. The current rent on the property is £750 but this could achieve more upon renewal.

Lease is 81 Years remaining  
 Maintenance is £1059 per annum  
 Ground Rent is £265 per annum

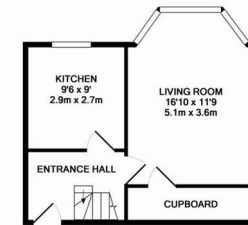

GROUND FLOOR  
 APPROX. FLOOR  
 AREA 357 SQ.FT.  
 (33.1 SQ.M.)

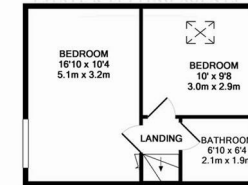

1ST FLOOR  
 APPROX. FLOOR  
 AREA 332 SQ.FT.  
 (30.8 SQ.M.)

TOTAL APPROX. FLOOR AREA 689 SQ.FT. (64.0 SQ.M.)

Whilst every attempt has been made to ensure the accuracy of the floor plan contained here, measurements of doors, windows, rooms and any other items are approximate and no responsibility is taken for any error, omission, or mis-statement. This plan is for illustrative purposes only and should be used as such by any prospective purchaser. The services, systems and appliances shown have not been tested and no guarantee as to their operability or efficiency can be given.  
 Made with Metronix CSD15

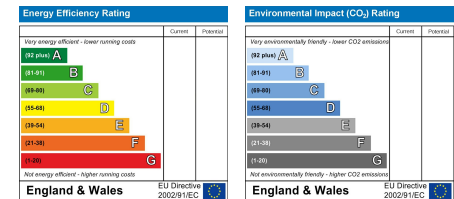

**Newstead Estate & Lettings Agents Ltd**  
 122-124 Castle Lane West, Bournemouth, Dorset, BH9 3JU  
 Tel: 01202 430 108  
 Email: info@newsteadproperty.co.uk  
 www.newsteadproperty.co.uk

**newstead**  
 ESTATE & LETTING AGENTS