



41 Chesildene Avenue

newstead
ESTATE & LETTING AGENTS

41 Chesildene Avenue, Throop, Bournemouth, BH8 0AZ



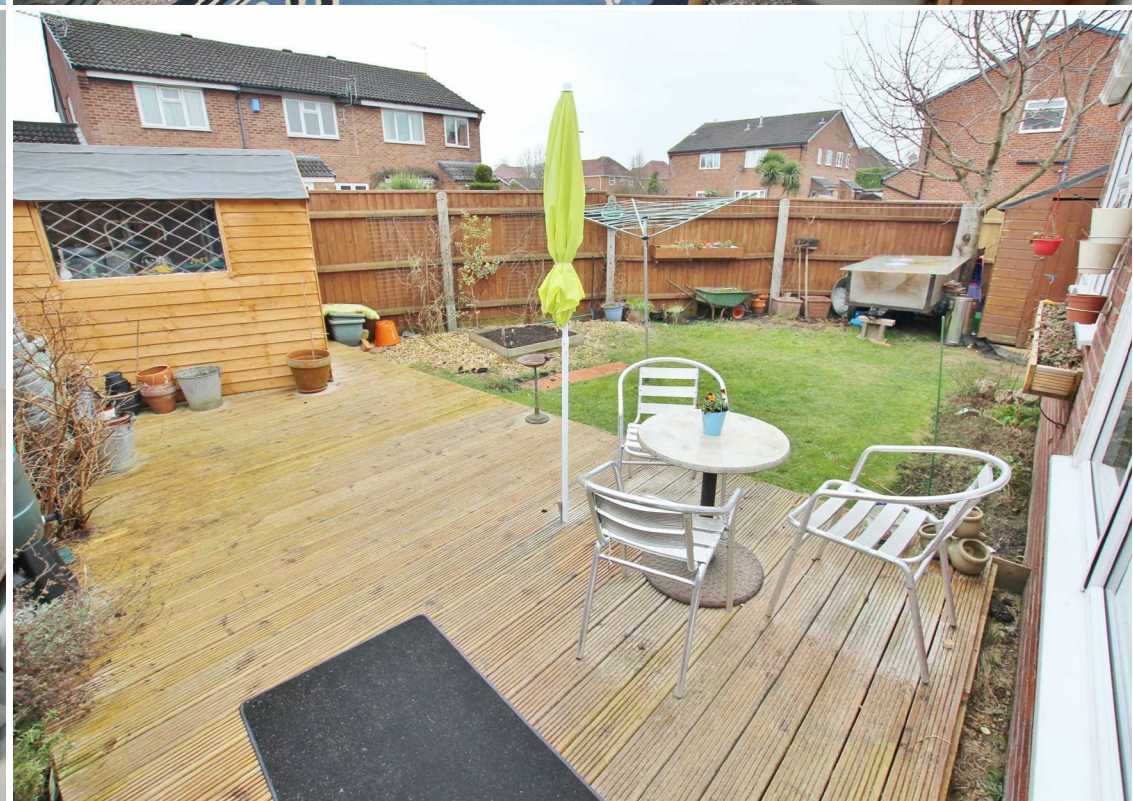

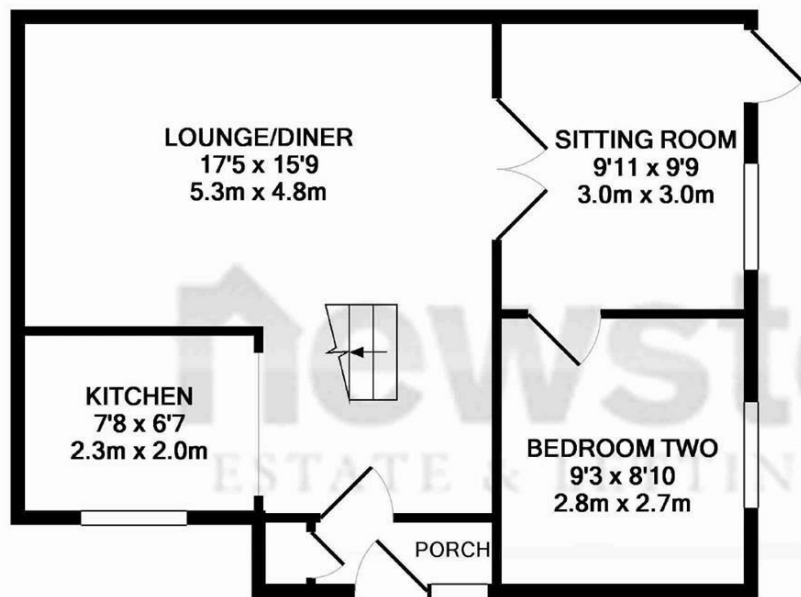

GROUND FLOOR
 APPROX. FLOOR
 AREA 479 SQ.FT.
 (44.5 SQ.M.)

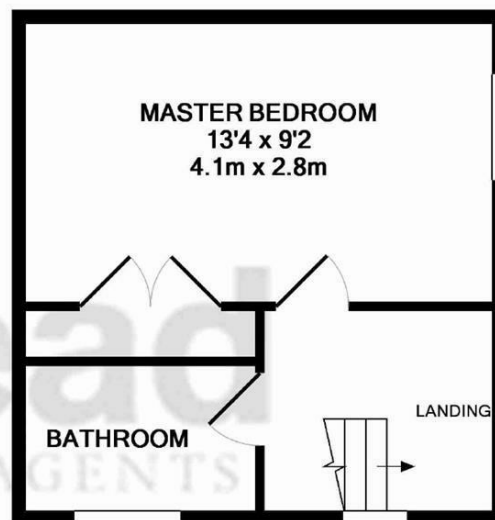

1ST FLOOR
 APPROX. FLOOR
 AREA 285 SQ.FT.
 (26.5 SQ.M.)

TOTAL APPROX. FLOOR AREA 764 SQ.FT. (71.0 SQ.M.)

Whilst every attempt has been made to ensure the accuracy of the floor plan contained here, measurements of doors, windows, rooms and any other items are approximate and no responsibility is taken for any error, omission, or mis-statement. This plan is for illustrative purposes only and should be used as such by any prospective purchaser. The services, systems and appliances shown have not been tested and no guarantee as to their operability or efficiency can be given

Made with Metropix ©2015

Energy Efficiency Rating

	Current	Potential
Very energy efficient - lower running costs		
(92 plus) A		91
(81-91) B		
(69-80) C		73
(55-68) D		
(39-54) E		
(21-38) F		
(1-20) G		
Not energy efficient - higher running costs		

England & Wales EU Directive 2002/91/EC

Environmental Impact (CO₂) Rating

	Current	Potential
Very environmentally friendly - lower CO ₂ emissions		
(92 plus) A		
(81-91) B		
(69-80) C		
(55-68) D		
(39-54) E		
(21-38) F		
(1-20) G	1	1
Not environmentally friendly - higher CO ₂ emissions		

England & Wales EU Directive 2002/91/EC

122-124 Castle Lane West,
 Bournemouth, Dorset, BH9 3JU
 Tel: 01202 430 108
 E: info@newsteadproperty.co.uk
 www.newsteadproperty.co.uk

IMPORTANT: we would like to inform prospective purchasers that these sales particulars have been prepared as a general guide only. A detailed survey has not been carried out, nor the services, appliances and fittings tested. Room sizes should not be relied upon for furnishing purposes and are approximate. If floor plans are included, they are for guidance only and illustration purposes only and may not be to scale. If there are any important matters likely to affect your decision to buy, please contact us before viewing the property.

newstead
 ESTATE & LETTING AGENTS