



Flat 2, 31 Queens Park Avenue, Bournemouth, Dorset, BH8 9LH
£975 Per Calendar Month



GROUND FLOOR FLAT - TWO DOUBLE BEDROOMS - LARGE BRIGHT OPEN PLAN LOUNGE AND KITCHEN - MODERN BATHROOM AND EN-SUITE - PARKING - SOUGHT AFTER LOCATION

This spacious modern ground floor flat is located in one of Bournemouth's premier tree lined avenues. The accommodation consists of a bright open plan living area and kitchen with integrated appliances and modern gloss fronted units.

The master bedroom is a generous size and has an adjoining en-suite shower room with fully tiled walls, walk-in corner shower cubicle, wash basin and WC. The second bedroom is also a good sized double and there is a master bathroom with shower over bath, basin and WC too.

The flat also comes with fitted storage in the hallway, gas central heating, UPVC double glazing, allocated parking for one car and secure entryphone system.

Available from 16th June 2016

No pets

No DSS

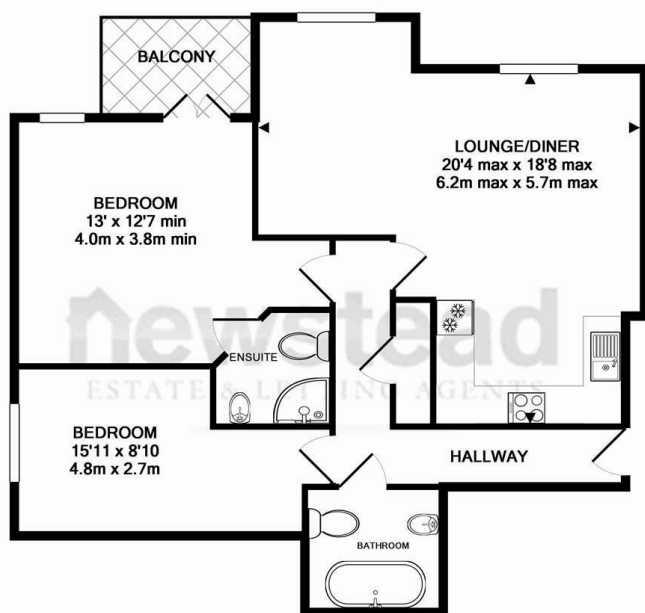

TOTAL APPROX. FLOOR AREA 786 SQ.FT. (73.0 SQ.M.)

Whilst every attempt has been made to ensure the accuracy of the floor plan contained here, measurements of doors, windows, rooms and any other items are approximate and no responsibility is taken for any error, omission, or mis-statement. This plan is for illustrative purposes only and should be used as such by any prospective purchaser. The services, systems and appliances shown have not been tested and no guarantee as to their operability or efficiency can be given

Made with Metropix ©2015

You may download, store and use the material for your own personal use and research. You may not republish, retransmit, redistribute or otherwise make the material available to any party or make the same available on any website, online service or bulletin board of your own or of any other party or make the same available in hard copy or in any other media without the website owner's express prior written consent.