



**26 Durweston Close, Bournemouth, Dorset, BH9 3QD
Offers In Excess Of £237,500**



An opportunity to acquire a spacious two bedroom house, situated in the sought after BH8, Throop location.

Entering the property there is a porch area which is great for storing shoes and coats. Leading from the porch you enter a sizable, well decorated lounge. To the rear of the property there is a spacious kitchen that benefits a range of base and wall mounted units and a door opening onto a private garden.

On to the first floor there are two double bedrooms, with plenty of space for freestanding wardrobes in the master and a built in storage cupboard in the second. There is a modern bathroom in between with shower over bath, basin and WC.

Outside of property you have a good sized rear garden which is mainly laid to lawn and a decked area at the start of the garden perfect for entertaining family and friends. As the property backs onto another garden it is extremely secluded. It is lined with fencing and mature shrubs, flowers and trees creating the perfect space to enjoy the summer months.

The property is located in the sought after BH9, Muscliff location, within close vicinity of Castle Lane West and its plethora of local shops, coffee houses and supermarkets. It is home to major bus routes in and out of Bournemouth and only a short drive from Castle Point Shopping Centre and the Wessex Way in and out of Bournemouth, perfect for commuters. You are also in close proximity to an abundance of primary and secondary schools; both grammar and public

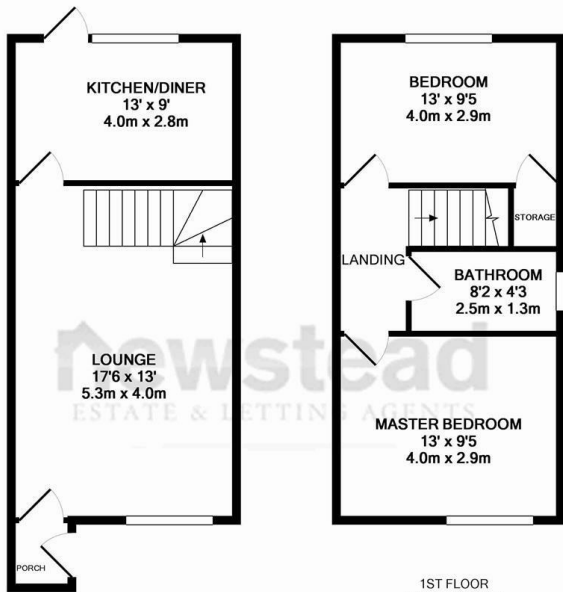

GROUND FLOOR
APPROX. FLOOR
AREA 350 SQ.FT.
(32.6 SQ.M.)

1ST FLOOR
APPROX. FLOOR
AREA 336 SQ.FT.
(31.2 SQ.M.)

TOTAL APPROX. FLOOR AREA 686 SQ.FT. (63.8 SQ.M.)

Whilst every attempt has been made to ensure the accuracy of the floor plan contained here, measurements of doors, windows, rooms and any other items are approximate and no responsibility is taken for any error, omission, or mis-statement. This plan is for illustrative purposes only and should be used as such by any prospective purchaser. The services, systems and appliances shown have not been tested and no guarantee as to their operability or efficiency can be given.

Made with Metropix ©2016

You may download, store and use the material for your own personal use and research. You may not republish, retransmit, redistribute or otherwise make the material available to any party or make the same available on any website, online service or bulletin board of your own or of any other party or make the same available in hard copy or in any other media without the website owner's express prior wr

Newstead Estate & Lettings Agents Ltd
122-124 Castle Lane West, Bournemouth, Dorset, BH9 3JU
Tel: 01202 430 108
Email: info@newsteadproperty.co.uk
www.newsteadproperty.co.uk

newstead
ESTATE & LETTING AGENTS