



Wolffe Gardens, London, E15 4JJ

Asking price £275,000

Sandra Davidson are pleased to present this three bedroom first floor flat situated within close proximity of local amenities and Maryland mainline train station. The property features 3 bedrooms, separate bathroom, fitted kitchen and is offered chain free. The property comprises:-

- Three Bedrooms
- Lounge
- Kitchen
- Bathroom
- Separate W.C.
- Long Lease
- Chain Free
- First Floor
- Double Glazed



ENTRANCE

Partly glazed door to entrance hall with fitted carpet, large storage cupboard, radiator, telephone entry system.

LOUNGE 4.86m x 3.73m (15'11" x 12'3")

Large UPVC double glazed window to front, two radiators, laminate wood flooring, fire surround with inset gas fire.

KITCHEN 4.86m x 1.78m (15'11" x 5'10")

Fitted wall and base units, work surface, single bowl single drainer stainless steel sink unit, tiled splash back, plumbing and services for washing machine and fridge/freezer, space for oven with extractor hood over, vinyl flooring, UPVC double glazed window to rear, built-in storage cupboard.

BEDROOM ONE 4.50m x 2.68m (14'9" x 8'10")

Double glazed window to front, radiator, fitted carpet, light

BEDROOM TWO 3.30m x 2.20m (10'10" x 7'3")

Double glazed window to front, radiator, fitted carpet, light

BEDROOM THREE 2.76m x 2.40m (9'1" x 7'10")

Double glazed window to front, radiator, fitted carpet, light

BATHROOM 1.57m x 1.37m (5'2" x 4'6")

White suite comprising panelled bath, wash hand basin, extractor fan, window to rear, partly tiled walls, vinyl flooring,

SEPARATE W.C.

Low level w.c, partly tiled walls, vinyl flooring, window to rear.



First Floor

Approx. 64.4 sq. metres (693.1 sq. feet)

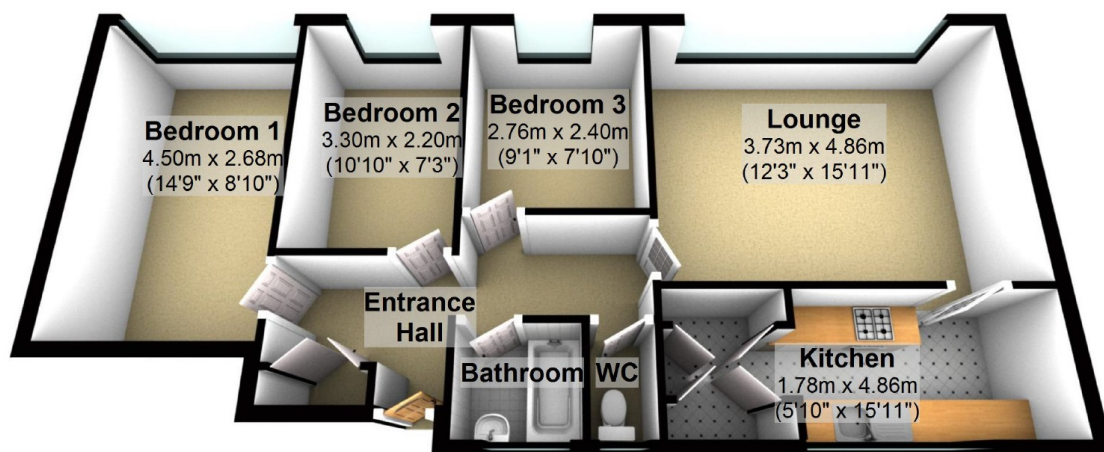

Total area: approx. 64.4 sq. metres (693.1 sq. feet)

This plan is for illustration purposes only and may not be representative of the property. Plan created by Sandra Davidson Estate

Agents www.sandradavidson.com

Plan produced using The Mobile Agent.