



THE PINNACLE, BATTERSEA REACH

£1,270,000



An elite three bedroom river-aspect apartment of 1,149 sq ft (106.75 sqm), with two secure underground parking allocations, available chain free as a brand new purchase for first time occupation.

The Pinnacle is the jewel in the crown of the exclusive community at Battersea Reach, offering superior internal specifications and an abundance of light from the full-height glazing. The apartments are finished to an immaculate specification that features American walnut and oak timber veneers, fine stone and porcelain tiling.

Battersea Reach itself provides many on-site amenities, including restaurants and bars, a residents only fitness suite, convenience shopping and a 24 hour concierge service. Available with remainder of 999 year leasehold and to view via Prime London.







THE PINNACLE, BATTERSEA REACH, LONDON SW18
GROSS INTERNAL AREA 1,149 SQ FT / 106.75 SQM

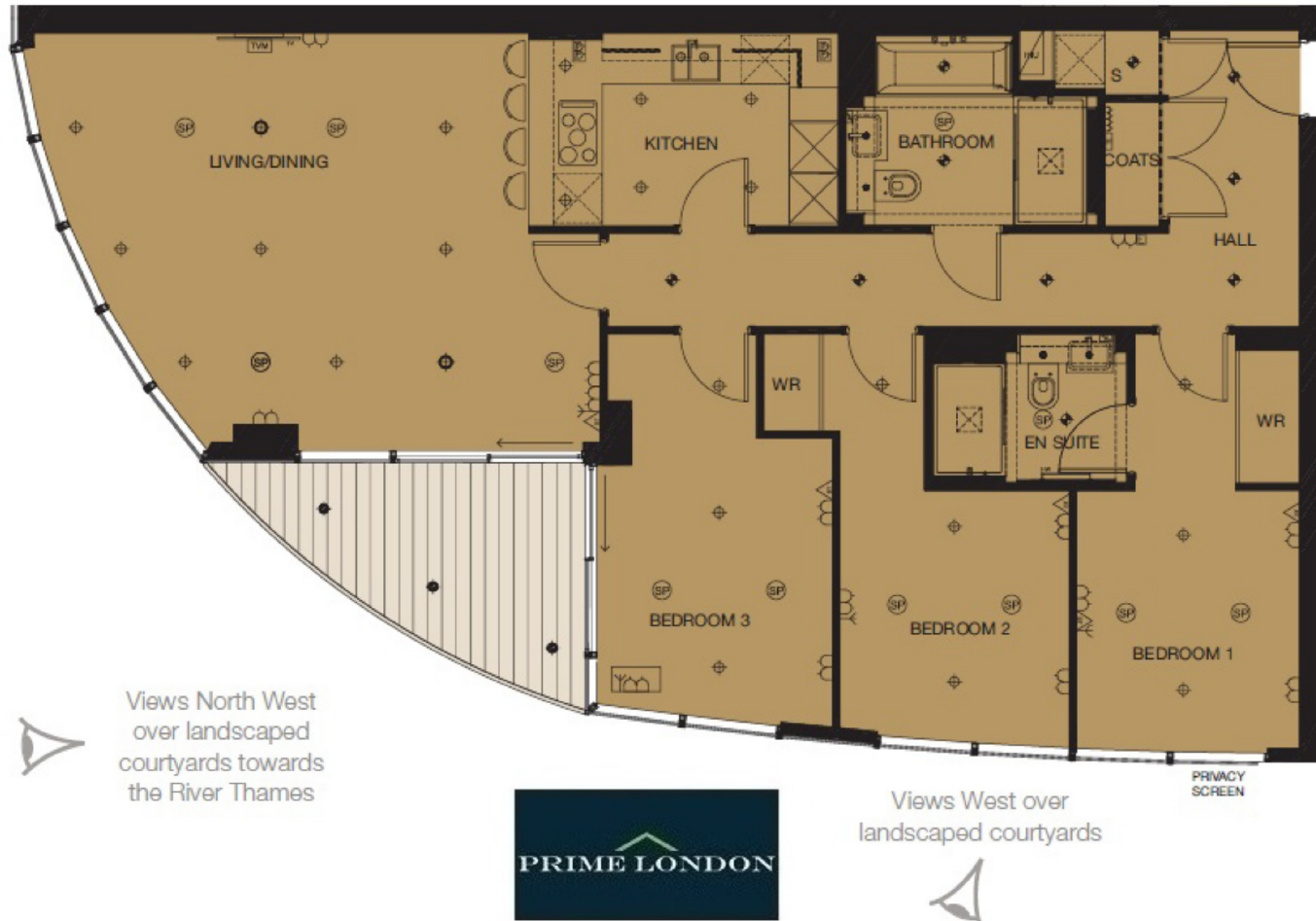

Views North West
over landscaped
courtyards towards
the River Thames

Views West over
landscaped courtyards

