



Morris Street, London, E1 2NP

Offers in excess of £475,000

Sandra Davidson are pleased to present this good size purpose built, three bedroom, split level first floor flat situated in a sought after location within walking distance of Shadwell DLR and underground station, local shops and amenities and local transport links. The property benefits from three double bedrooms, fitted kitchen/diner, lounge with own balcony and would be ideal for a first time buyer looking to get a foot on the property ladder or an investor looking for a good investment.



ENTRANCE

Via communal door with entry phone system to communal entrance hallway with stairs to first floor.

Via wooden door to entrance hall with laminate wood flooring, doors to:-

LOUNGE

Double glazed window to rear, wood flooring, radiator, door to balcony

KITCHEN DINER

Fitted wall and base units work surface with tiled splash back, space and services for washing machine, four ring gas hob, wood flooring, double glazed window to front, cupboard housing metres

FIRST FLOOR LANDING

Fitted carpet, light, cupboard housing boiler, doors to:-

BEDROOM ONE

Double glazed window to front, radiator, fitted cupboards, wood flooring.

BEDROOM TWO

Double glazed window to rear, wood flooring,

BEDROOM THREE

Double glazed window to rear with radiator under, fitted storage, wood flooring.

BATHROOM

Bathtub with shower over, pedestal hand wash basin, partly tiled walls, tiled flooring, radiator, double glazed window to front

SEPARATE WC

WC with high level pull chain cistern. Double glazed window to front, partly tiled walls, tiled flooring

EXTERIOR

Communal gardens and allocated parking



Ground Floor

Approx. 31.3 sq. metres (337.0 sq. feet)

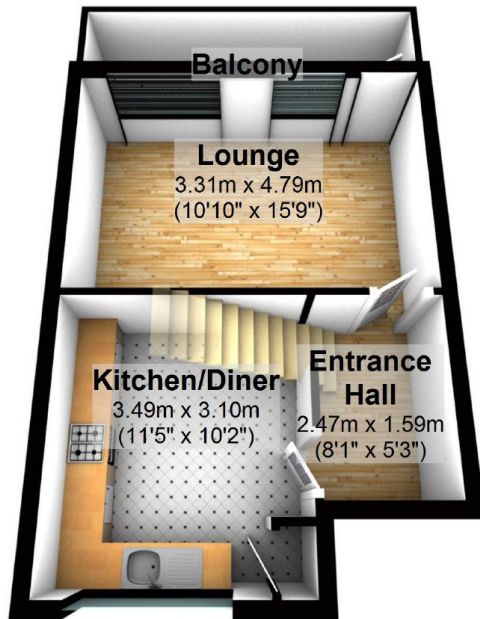

First Floor

Approx. 40.7 sq. metres (438.2 sq. feet)

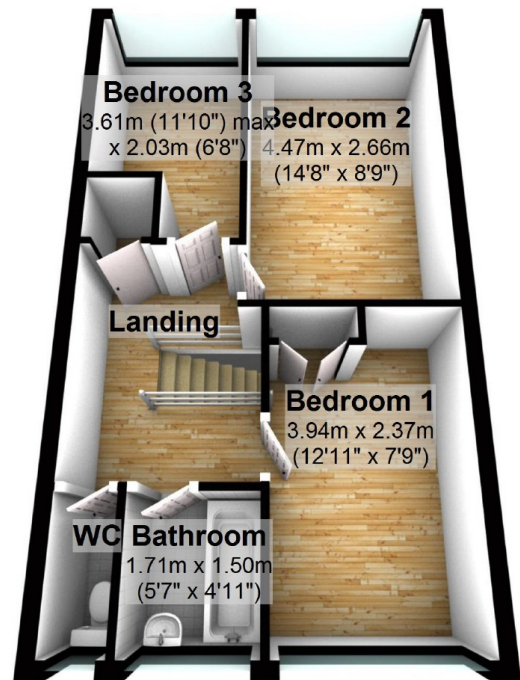

Total area: approx. 72.0 sq. metres (775.2 sq. feet)

This plan is for illustration purposes only and may not be representative of the property Plan created by Sandra Davidson Estate Agents www.sandradavidson.com
Plan produced using PlanUp.