





OIEO £450,000

This beautifully presented three bedroom terraced house is situated in the stylish and modern Trinity Village development at Bromley Common.

The property consists of an entrance hallway with storage cupboard, WC, a beautifully presented living room, separate fully fitted gloss black kitchen incorporating a dining area with further storage cupboard and French doors leading to the rear private garden.

On the first floor is a master bedroom including fitted wardrobes and a further two bedrooms with the family bathroom.

The private rear garden measures 33'01 x 14'02 and includes laid lawn, decked entertaining area and rear access.

The property also benefits from the remainder of new home warranty of approximately 1 year and NHBC cover of approximately 6 years, an allocated parking space and although this is a freehold property there is a maintenance charge of approximately £80.00 twice a year for the development maintenance.

The property is ideally located for local schools, bus routes and Bromley Town centre with its variety of shops, restaurants, bars, train stations and Into Bromley Shopping Centre.

Offered chain free.



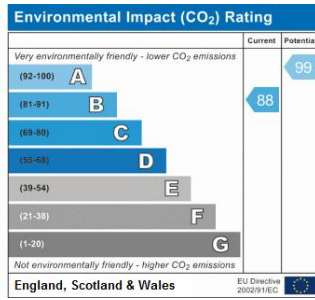
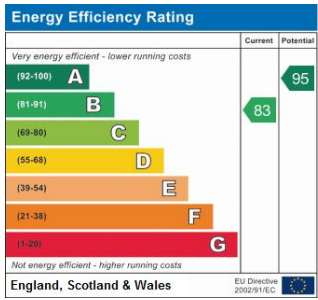

Please refer to

---

[www.jdmestateagents.com](http://www.jdmestateagents.com)

---

to view our full area guides



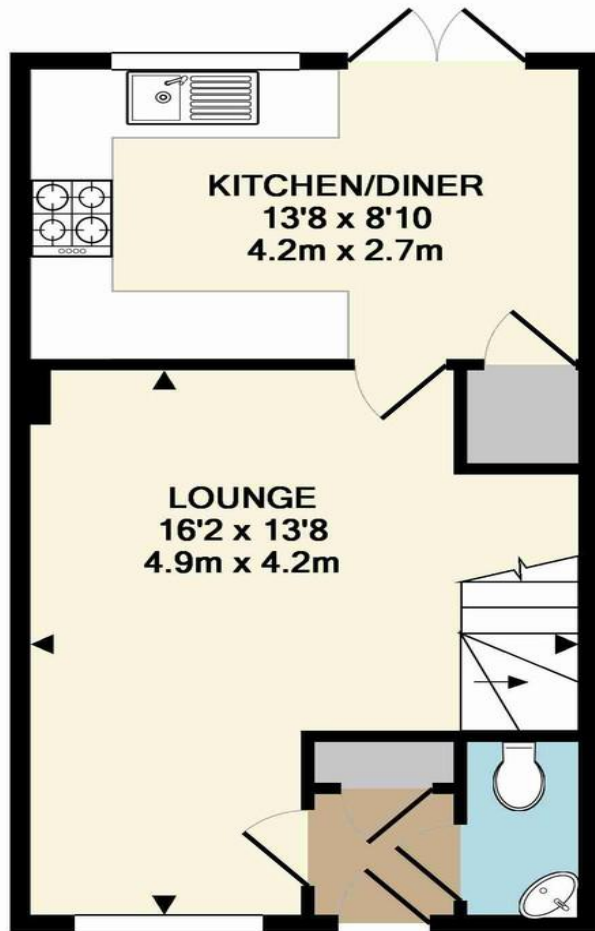

GROUND FLOOR  
APPROX. FLOOR  
AREA 340 SQ.FT.  
(31.6 SQ.M.)

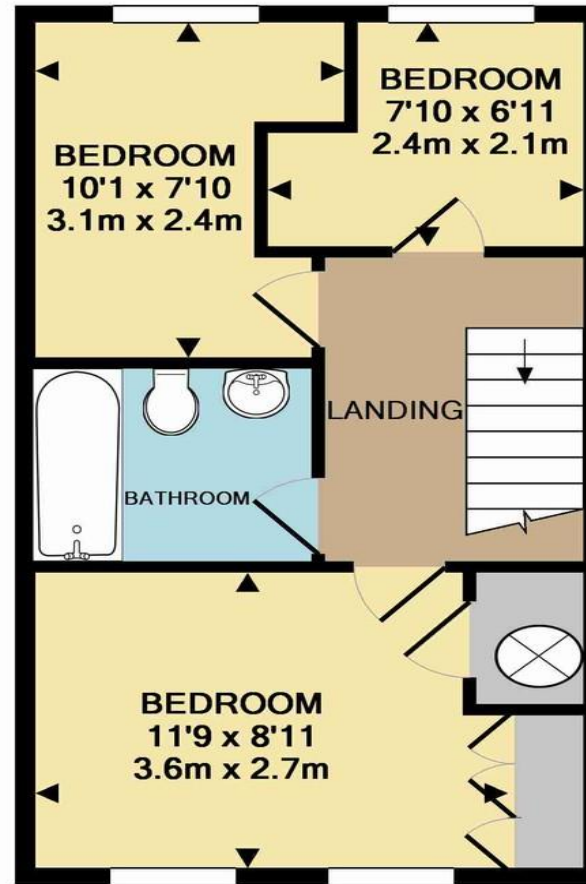

1ST FLOOR  
APPROX. FLOOR  
AREA 342 SQ.FT.  
(31.7 SQ.M.)

TOTAL APPROX. FLOOR AREA 682 SQ.FT. (63.3 SQ.M.)

Whilst every attempt has been made to ensure the accuracy of the floor plan contained here, measurements of doors, windows, rooms and any other items are approximate and no responsibility is taken for any error, omission, or mis-statement. This plan is for illustrative purposes only and should be used as such by any prospective purchaser. The services, systems and appliances shown have not been tested and no guarantee as to their operability or efficiency can be given

Made with Metropix ©2016

