





Guide Price £630,000 - £650,000. Tucked away just off Lee Road, the main artery to Blackheath Village, this immaculately presented, three bedroom popular 'Gough Cooper' house has been loved and cared for by the current owner for 20 years. Looks can be deceiving! This property offers spacious accommodation with plenty of natural light.

Sims Walk is a fabulous location, conveniently situated for Lee and just half a mile from Blackheath Village with its vibrant surroundings, handy transport links and an array of walk-to amenities, not to mention the DLR only a short bus journey away. Additional features include well tended garden with gated rear access & own garage in block.



Please refer to

www.jdmestateagents.com

to view our full area guides



Sims Walk

APPROX. GROSS INTERNAL FLOOR AREA 955.19 SQFT / 88.74 SQM.

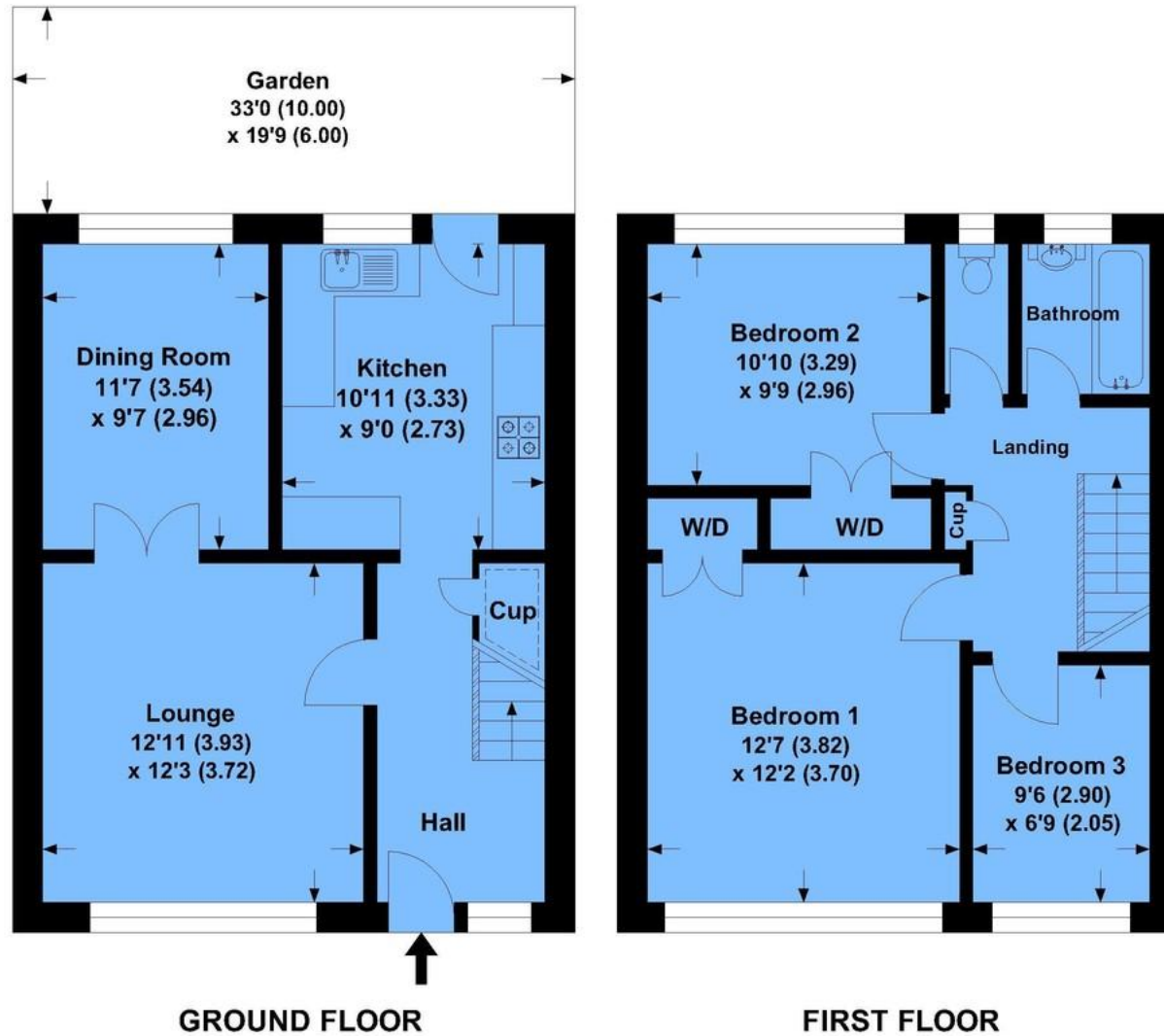

This is for guidance only, not to scale and must not be relied upon as a statement of fact.
Attention is drawn to the notice on these particulars.

