





£525,000

This charming three bedroom cottage comes to the market in good decorative order and features a modern fitted kitchen with some integral appliances, a bathroom fitted with a contemporary white suite and a spacious, light and airy through lounge/diner.

To the rear is a delightful garden with a patio area, lawn and flower borders.

There is off street parking to the rear accessed via a rear service road.

The location is excellent being in the heart of the village close to the high street, common and ponds.



Early viewing is highly recommended.

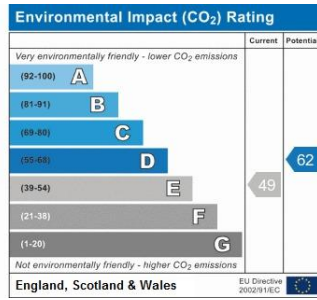
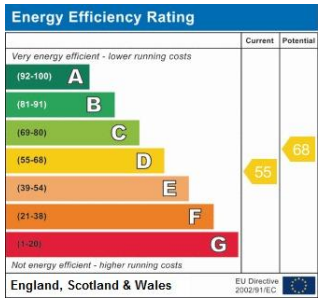

Please refer to

www.jdmestateagents.com

to view our full area guides



Green Lane

APPROX. GROSS INTERNAL FLOOR AREA 979.54 SQFT / 91.00 SQM.

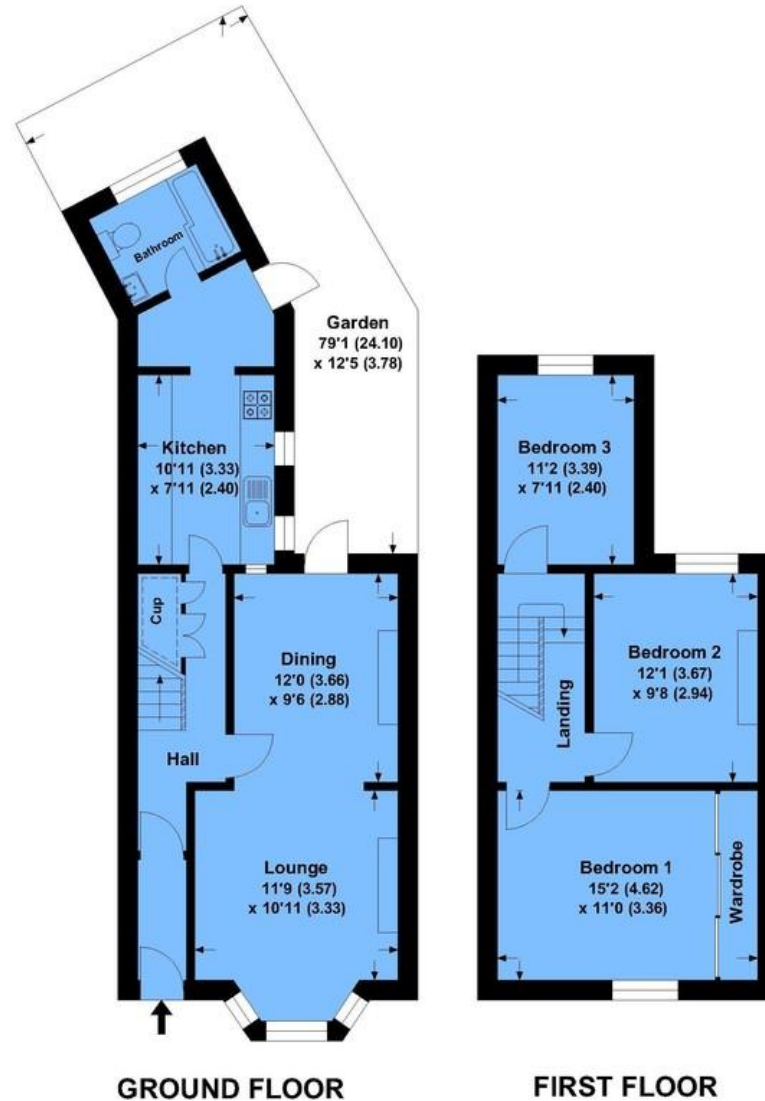

This is for guidance only, not to scale and must not be relied upon as a statement of fact.
Attention is drawn to the notice on these particulars.

