





A neutrally presented three bedroom terraced house which has been owned and cared for by the same family for the last 81 years.

The property is an ideal first time purchase and benefits from recently fitted carpets and flooring throughout. The ground floor accommodation comprises a light and spacious open plan living/dining room and a kitchen with space for appliances and a door to the rear garden. Upstairs there are two large double bedrooms, a single bedroom plus a shower room.

The 92' rear garden benefits from mature planting of shrubs and trees and a lawn area. To the front is a well stocked garden with a path leading to the front door.

The property is offered with no onward chain and an early viewing is highly recommended.



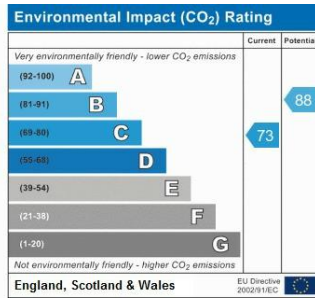
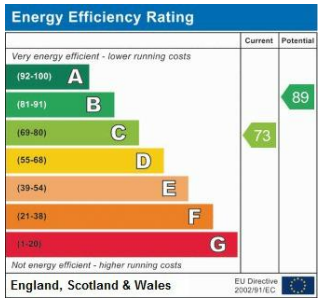

Please refer to

---

[www.jdmestateagents.com](http://www.jdmestateagents.com)

---

to view our full area guides



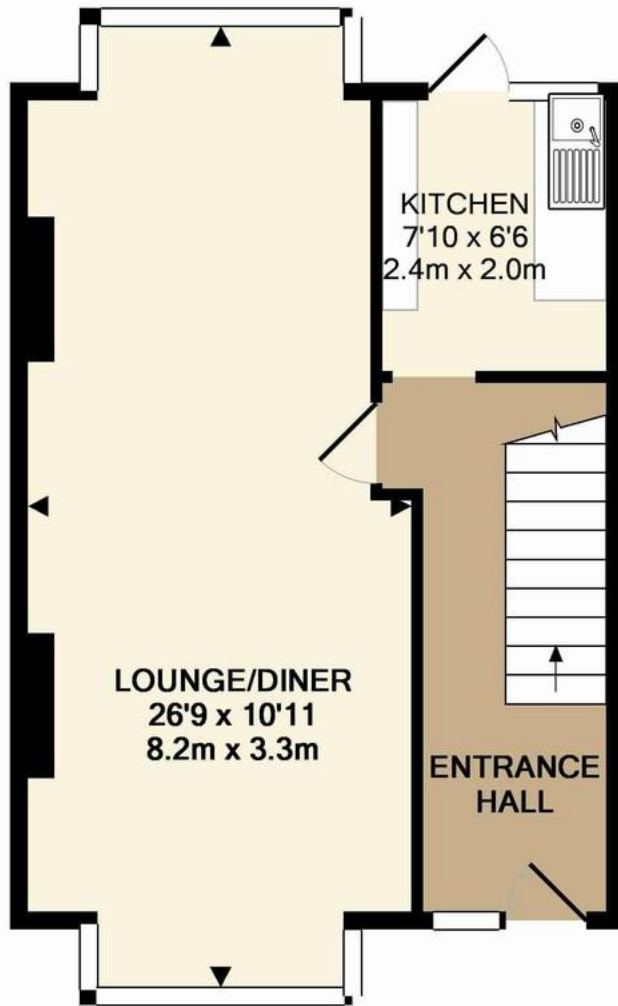

GROUND FLOOR  
APPROX. FLOOR  
AREA 392 SQ.FT.  
(36.4 SQ.M.)

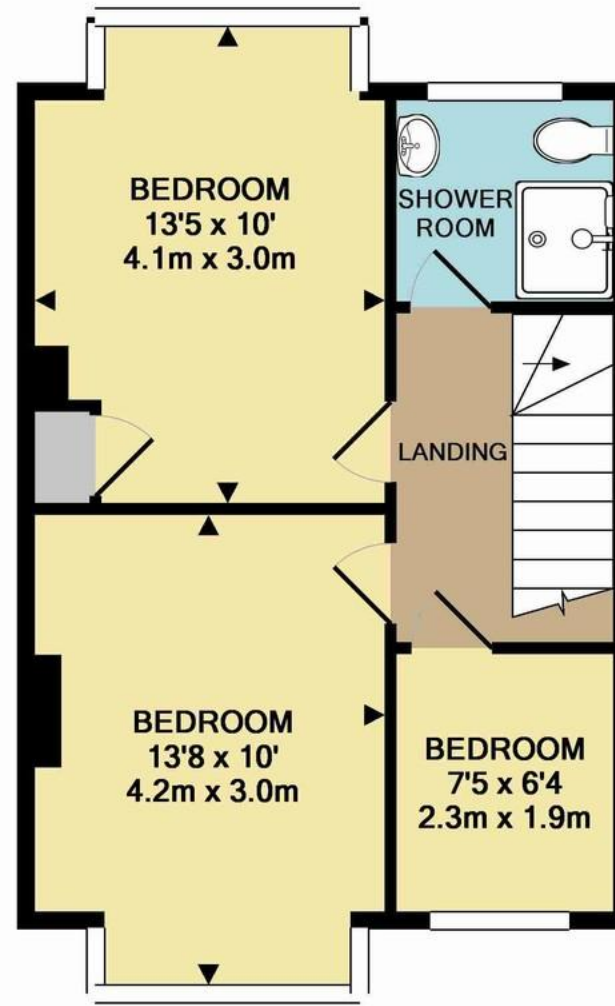

1ST FLOOR  
APPROX. FLOOR  
AREA 394 SQ.FT.  
(36.6 SQ.M.)

