

Neville House, 67 Wellingborough Road,  
Rushden, Northamptonshire, NN10 9YG  
T: 01933 316316  
E: sales@mike-neville.co.uk  
www.mike-neville.co.uk

**Mike  
Neville**  
ESTATE AGENTS



**5 Saxon Rise, Irchester  
Northamptonshire NN29 7AU**



**£129,950 Freehold**

An ideal first time purchase, buy to let investment or family home comes in the form of this three bedroom town home situated in the popular village of Irchester. The property benefits from a lounge, kitchen/diner, off road parking for two vehicles and pleasant enclosed rear garden. An early viewing is strongly recommended.

- Three bedrooms
- Landing
- Good size lounge
- PVC double glazing
- Off road parking for two vehicles
- Bathroom/w.c
- Hall
- Kitchen/dining room
- Gas radiator central heating
- All main services connected



**Bedroom 2 11'1" x 6'7" (3.37m x 2.01m)**  
Maximum including built in wardrobe

**Bedroom 3 7'10" x 6'2" (2.39m x 1.88m)**

**Bathroom/W.C**

**Landing**

**Additional Information**

Wall mounted gas fired combination boiler for central heating and hot water, situated in cupboard in bedroom 2.  
Loft access on landing.

**Outside**

**Front**

Off road parking for two vehicles is provided.

**Rear Garden**

A pleasant, enclosed, rear garden with rear gated access.



**Council Tax Band**

B

**Energy Rating**

C

**Accommodation**

**Ground Floor**

**Hall**

**Lounge 16'7" x 9'9" (5.05m x 2.98m)**

Minimum plus recess plus understairs cupboard



**Kitchen/Dining Room 9'11" x 13'1" (3.02m x 3.99m)**



**First Floor**

**Bedroom 1 8'11" x 11'0" (2.71m x 3.36m)**

Plus built in wardrobes

**Disclaimer**

AGENTS NOTE - ALL MEASUREMENTS ARE APPROXIMATE. ANY APPLIANCES MENTIONED HAVE NOT BEEN TESTED BY OURSELVES. MONEY LAUNDERING REGULATIONS 2007 – We are required to show due diligence in obtaining proof of identity on or before the date the purchaser's offer is accepted by the vendor (seller). Floor plans are for identification purposes only and not to scale. Measurements are approximate. Wall thickness, door and window sizes are approximate. Prospective purchasers are strongly advised to check all measurements prior to purchase. Mike Neville Estate Agents for themselves and the Vendors/Lessors of this property, give notice that (a) these particulars are produced in good faith as a general guide only and do not constitute or form part of a contract (b) no person in the employment of Mike Neville has authority to give or make any representation or warranty whatsoever in relation to the property.



## Ground Floor

Approx. 33.7 sq. metres (362.3 sq. feet)

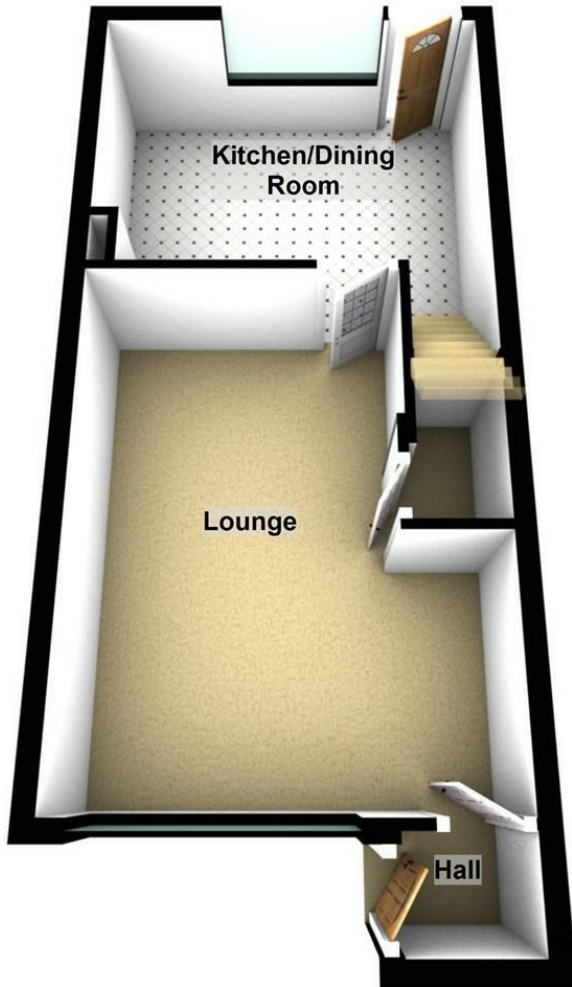

## First Floor

Approx. 32.5 sq. metres (350.2 sq. feet)

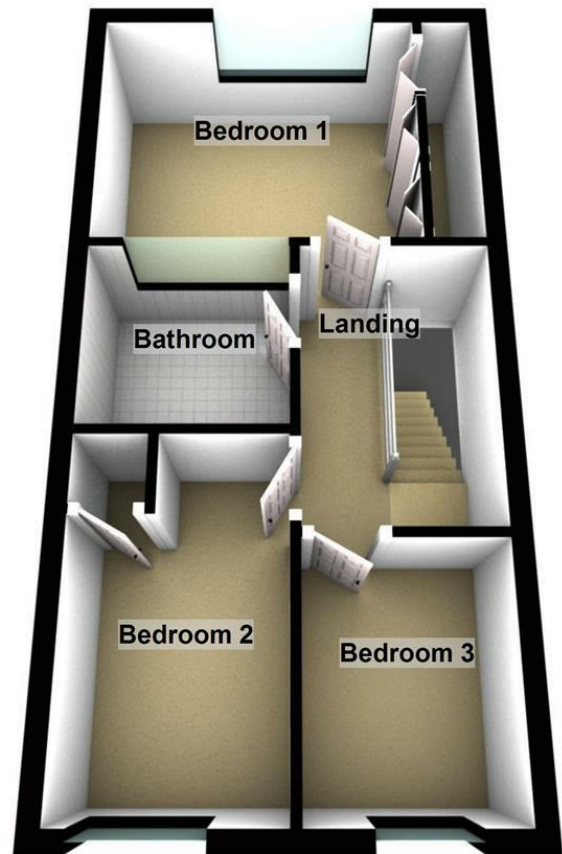

Total area: approx. 66.2 sq. metres (712.5 sq. feet)

Sales and Lettings Offices



RUSHDEN  
01933 316316

BEDFORD  
01234 327455

WOBURN  
01525 290393

HITCHIN  
01462 438979

Registered in England 4144174

Auction Rooms  
CHARLES ROSS  
FINE ART AUCTIONEERS  
AND VALUERS  
01525 290502