



12 Edifred Road, Bournemouth, Dorset, BH9 3PD
£274,950



IN NEED OF MODERNISATION - An opportunity to acquire a three double bedroom detached bungalow with a lounge/diner and sizable kitchen. In need of some modernization throughout this sizable character home gives an opportunity to create your perfect home and is in the sought after Edifred Road set on a sizable plot.

The property consists of three double bedrooms and a large lounge/diner, sizable kitchen and a family sized bathroom. To the rear of the property you have a large south facing garden. The property offers huge potential and could possibly be extended STPP.

The Property is located in the sought after BH9, Muscliff location, within close vicinity of Castle lane west and its plethora of local shops, coffee houses and supermarkets. It is home to major bus routes in and out of Bournemouth and only a short drive from castle point shopping centre and the Wessex way in and out of Bournemouth, perfect for commuters. You are also in close proximity to an abundance of primary and secondary schools; both grammar and public.

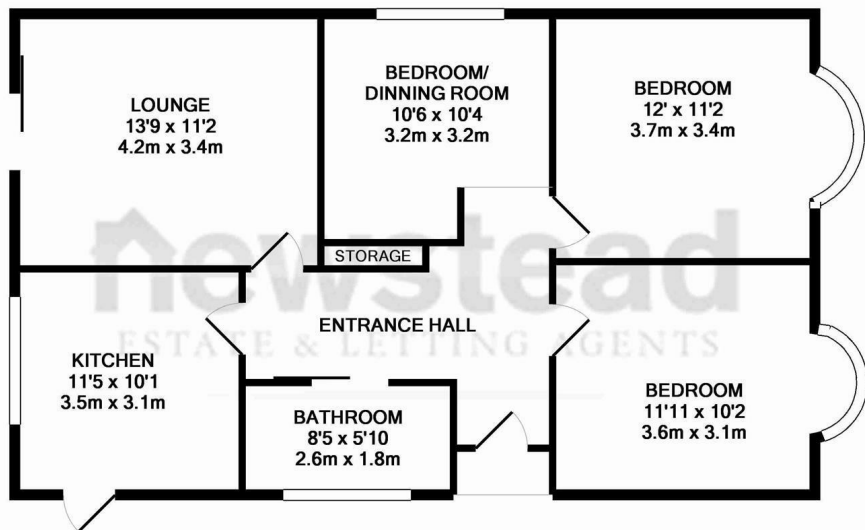

TOTAL APPROX. FLOOR AREA 797 SQ.FT. (74.0 SQ.M.)

Whilst every attempt has been made to ensure the accuracy of the floor plan contained here, measurements of doors, windows, rooms and any other items are approximate and no responsibility is taken for any error, omission, or mis-statement. This plan is for illustrative purposes only and should be used as such by any prospective purchaser. The services, systems and appliances shown have not been tested and no guarantee as to their operability or efficiency can be given
 Made with Metropix ©2015

You may download, store and use the material for your own personal use and research. You may not republish, retransmit, redistribute or otherwise make the material available to any party or make the same available on any website, online service or bulletin board of your own or of any other party or make the same available in hard copy or in any other media without the website owner's express prior wr