



19 Fritham Gardens, Bournemouth, Dorset, BH8 0EL
Guide Price £299,950



EXTENDED FAMILY HOME - A three bedroom semi-detached property located in a desirable location. The property benefits from 22'10 lounge/diner with large kitchen/dinner and conservatory at rear overlooking garden, three bedrooms with modern fitted kitchen and bathroom, ample off road parking, and garage.

The drive and frontage create ample off road parking with the home being set back from the road. On entry into the house, on the ground level the versatile and spacious accommodation comprises of large lounge/dinner including a large conservatory.

To complete the accommodation on the ground floor you have substantial modernised kitchen breakfast room with integrated appliances . This ground level accommodation is perfect to accommodate a family and offers the ideal space for entertaining family and friends.

Moving to the 2nd floor of this property has three bedrooms comprising of two doubles, and one single, the master and bedroom two come complete with built in wardrobes. And bedroom three with a large storage area. To complete the 2nd floors accommodation you have a modernised family bathroom suite.

Outside, the south westerly facing garden is positioned in a secluded location offering a good degree of privacy and is mainly laid to lawn.

The Property is located in the sought after BH8, Throop location, within close vicinity of Castle lane west and its plethora of local shops, coffee houses and supermarkets. It is home to major bus routes in and out of Bournemouth and only a short drive from castle point shopping centre and the Wessex way in and out of Bournemouth, perfect for commuters. You are also in close proximity to an abundance of primary and secondary schools; both grammar and public.

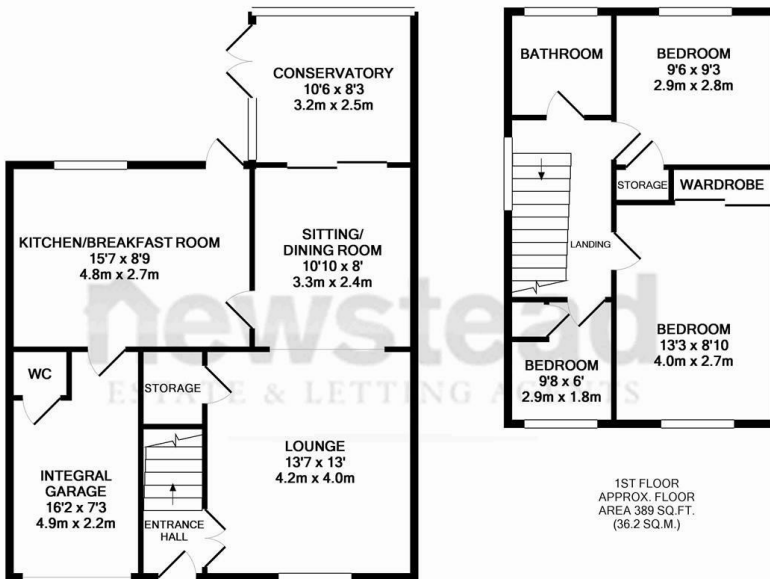

GROUND FLOOR
APPROX. FLOOR AREA 678 SQ.FT. (63.0 SQ.M.)

TOTAL APPROX. FLOOR AREA 1067 SQ.FT. (99.2 SQ.M.)

Whilst every attempt has been made to ensure the accuracy of the floor plan contained here, measurements of doors, windows, rooms and any other items are approximate and no responsibility is taken for any error, omission, or mis-statement. This plan is for illustrative purposes only and should be used as such by any prospective purchaser. The services, systems and appliances shown have not been tested and no guarantee as to their operability or efficiency can be given.
Made with Metropix ©2016

You may download, store and use the material for your own personal use and research. You may not republish, retransmit, redistribute or otherwise make the material available to any party or make the same available on any website, online service or bulletin board of your own or of any other party or make the same available in hard copy or in any other media without the website owner's express prior wr