



Paulsgrove, Orton Wistow, Peterborough, PE2 6YF

£470 Per Calendar Month : Available Now!

P1239

ProgressiveL^{et}s  Lettings

Paulsgrove, Orton Wistow, Peterborough, PE2 6YF

Refurbished one bedroom clipper home located in the popular residential area of Orton Wistow in quiet cul de sac. The property is located close to local amenities including Lynchwood business park, local shops, bus routes and major road links. The property benefits from UPVC double glazing, electric heating, attractive fitted kitchen, bathroom with electric shower over the bath, allocated off road parking and separate enclosed rear garden. The kitchen is fitted with attractive units and shelving including built in oven and hob, stainless steel work surfaces and ceramic tiled flooring. There is space and plumbing for a washing machine and space for a fridge/freezer. The lounge is open plan to the kitchen area and is a good size measuring approximately 12'6 x 13'7 max with full length

- Q-Type House
- Unfurnished Property
- Econ 7
- Sorry, No Smokers
- Sorry, No Pets Allowed
- Small Garden
- Sorry, No DSS
- Allocated Parking Available
- 1 Bedroom
- 1 Reception
- 1 Bathroom
- Orton Wistow

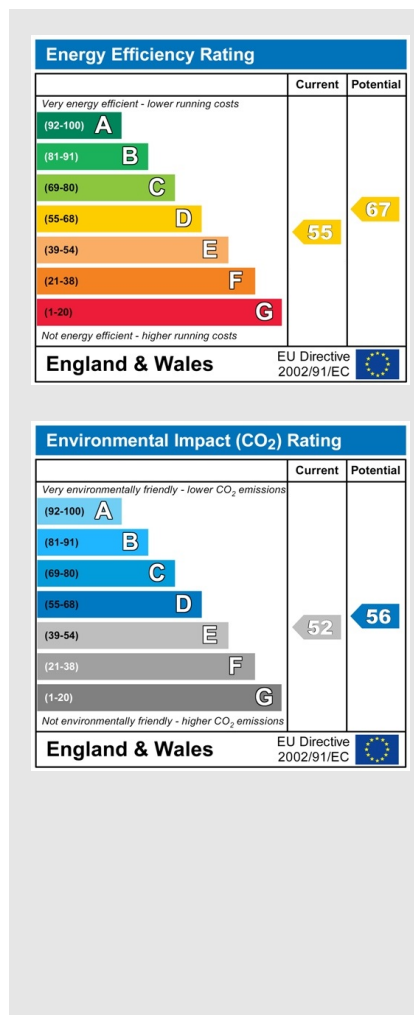

£470 Per Calendar Month

Ground Floor

Approx. 22.5 sq. metres (242.2 sq. feet)

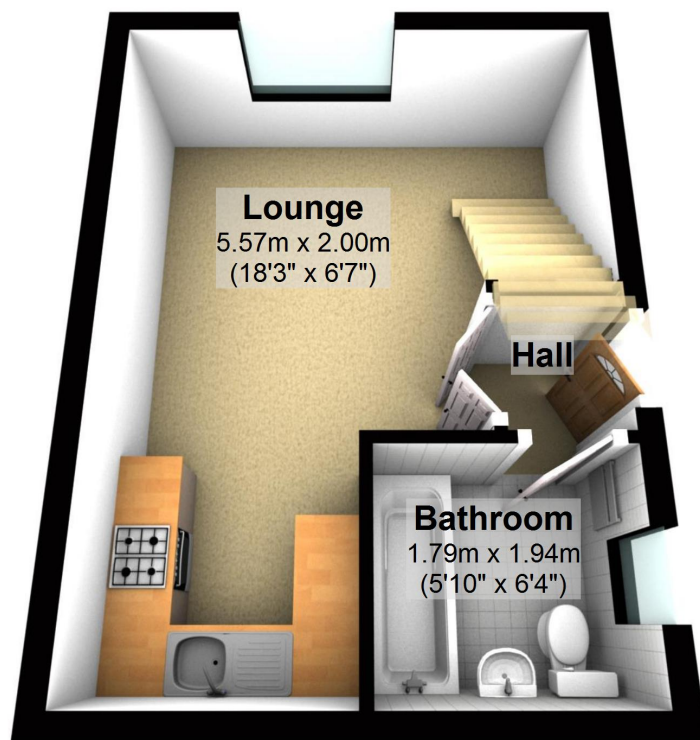

First Floor

Approx. 22.7 sq. metres (244.6 sq. feet)

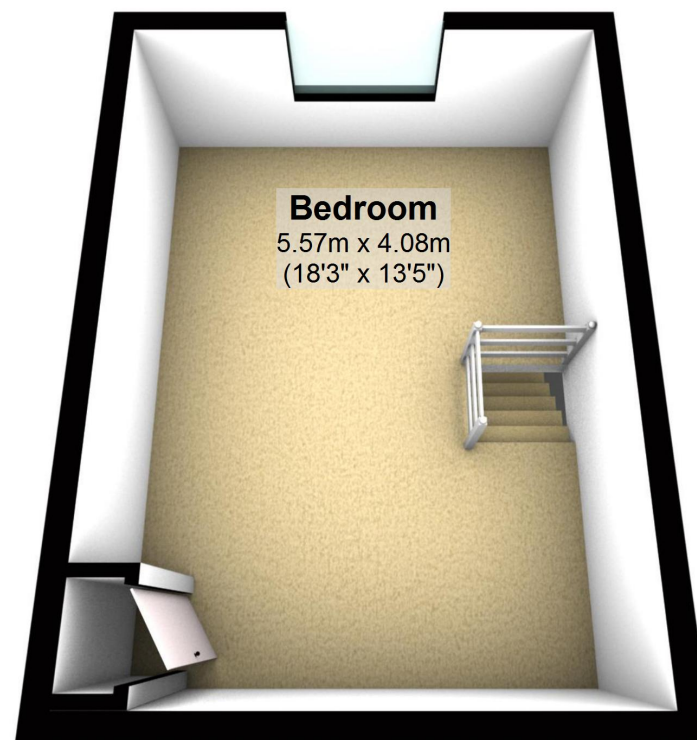

Total area: approx. 45.2 sq. metres (486.8 sq. feet)

