



PARK WEST, W2

Price
£350,000

Located on the 8th floor of this popular purpose built development in this studio apartment with separate kitchen. The accommodation comprises of studio room, kitchen and bathroom. Added benefits include lift and 24 hour porter. Park West is wonderfully located just a short walk from Marble Arch tube station, Edgware Road, Oxford Street and the open spaces of Hyde Park.

Details

Studio Room
Kitchen
Bathroom
24 Hour Porter
Lifts



Park West Kendal Street, W2



Approx. Gross Floor Area = 26 sq.meters • 284 sq.feet

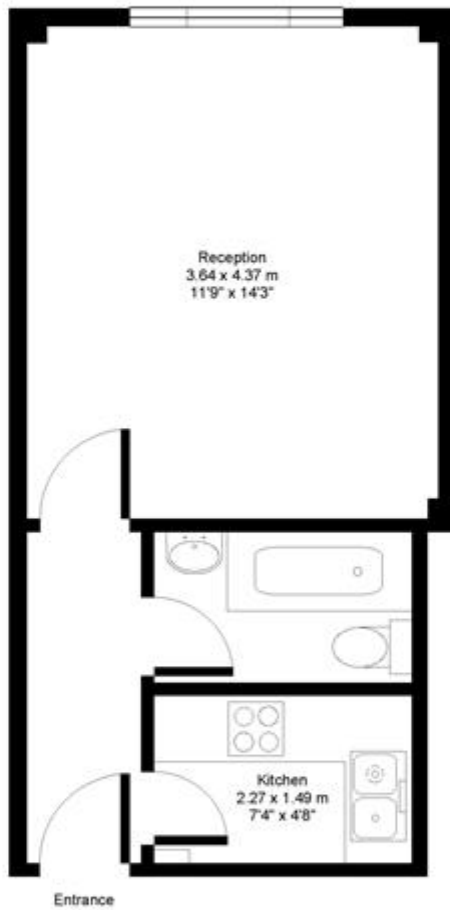

EIGHTH FLOOR

For illustrative purposes only. Not to scale. Prepared by Swan Photography 07974 264576

Terms and Conditions

Tenure: 88 years
 Borough: Westminster
 Price: £350,000

EPC Information

Energy Performance Certificate

Flat 566 Park West, Edgware Road, LONDON, W2 2RA

Dwelling type: Top-floor flat Reference number: 2399-5091-7265-3765-5660
 Date of assessment: 21 August 2015 Type of assessment: RdSAP, existing dwelling
 Date of certificate: 22 August 2015 Total floor area: 26 m²

Use this document to:

- Compare current ratings of properties to see which properties are more energy efficient
- Find out how you can save energy and money by installing improvement measures

Estimated energy costs of dwelling for 3 years:	£ 1,458
Over 3 years you could save	£ 141

Estimated energy costs of this home

	Current costs	Potential costs	Potential future savings
Lighting	£ 96 over 3 years	£ 63 over 3 years	
Heating	£ 1,095 over 3 years	£ 957 over 3 years	
Hot Water	£ 297 over 3 years	£ 297 over 3 years	
Totals	£ 1,458	£ 1,317	

These figures show how much the average household would spend in this property for heating, lighting and hot water. This excludes energy use for running appliances like TVs, computers and cookers, and any electricity generated by microgeneration.

Energy Efficiency Rating

The graph shows the current energy efficiency of your home.

The higher the rating the lower your fuel bills are likely to be.

The potential rating shows the effect of undertaking the recommendations on page 3.

The average energy efficiency rating for a dwelling in England and Wales is band D (rating 60).

Top actions you can take to save money and make your home more efficient

Recommended measures	Indicative cost	Typical savings over 3 years	Available with Green Deal
1. Low energy lighting for all fixed outlets	£10	£ 27	✓
2. Replace single glazed windows with low-E double glazed windows	£3,300 - £6,500	£ 114	✓

To find out more about the recommended measures and other actions you could take today to save money, visit www.direct.gov.uk/savingenergy or call 0300 123 1234 (standard national rate). The Green Deal may allow you to make your home warmer and cheaper to run at no up-front cost.

SUBJECT TO CONTRACT

VIEWING STRICTLY BY APPOINTMENT